

FMD Tutorial

Table of contents

1	The System Design	4
1.1	The basic design of the medAspis FMD system	4
2	The User Interface	5
2.1	The Speed Scanner	5
2.1.1	The User Interface of the Speed Scanner	5
2.2	The Control Panel	6
3	Setting up the System	7
3.1	A new account	7
3.2	Log on to the system	7
3.2.1	Password complexity	7
3.3	Manage your own account	7
3.4	Complete organisation	8
3.5	Setting up a Speed Scanner (server side)	9
3.6	Setting up a Speed Scanner (device)	10
3.7	Register at NMVS	10
3.7.1	Access to the Arvato system	11
3.7.2	Access to the Solidsoft system	12
3.7.3	Access to the securPharm system	12
3.8	User login to the Speed Scanner	13
3.9	First steps	15
4	The Speed Scanner	16
4.1	Working with the Speed Scanner	16
4.1.1	Available FMD Operations	17
4.2	Transfer the recorded code to the NMVS	17
4.2.1	Scan a 2D matrix code	17
4.2.2	Scan Accelerator	17
4.2.3	Processing of NMVS Response	17
4.2.4	Batch Control	18
4.2.5	Data collection only	18
4.2.6	Reading Crypto Codes	18
4.3	Performing FMD Operations	19
4.3.1	Verify	19
4.3.2	Dispense	19
4.3.3	Double Dispense	20
4.3.4	Double Dispense Filter is switched off in certain situations	20
4.3.5	Reactivate	21
4.3.6	Manual Entry	21
4.3.7	Offline Mode	22
4.4	The Speed Scanners settings	22
5	The Scan History	24
5.1	Working with the Scan History	24
5.1.1	Sort data	25

5.1.2	General filters	25
5.1.3	Search functions in the table	25
5.1.4	Export data	26
5.1.5	Display of additional Information	26
5.1.6	Offline Mode	27
5.1.7	The context menu	28
5.2	Settings of the Scan History	28
5.2.1	Number of records displayed	28
5.2.2	Detailed information to a Scan	28
5.2.3	Visible Columns in the Scan History	29
6	Performing Grouping Operations	30
6.1	Groupings	30
6.1.1	Grouping on the Speed Scanner	30
6.1.2	Grouping on the Control Panel	31
6.1.3	View of a Single Grouping	31
6.2	FMD Operations on groupings	33
6.2.1	Perform FMD operations on groupings	33
6.2.2	Special features of bulk operation in the Arvato system	34
6.2.3	Mixed Bulk Operation	34
6.3	Working with Groupings	35
6.3.1	Status of a Grouping	35
6.4	Aggregation as a special form of grouping	35
6.4.1	Aggregation Code as primary key of any Grouping	35
6.4.2	Hierarchical structure of aggregates	35
6.4.3	Exporting aggregations	36
6.4.4	Aggregation codes on stickers	36
7	Active Alert Management	37
7.1	Preventing false alarms with Alert Protect	37
7.1.1	Double Dispense Filter	37
7.2	Solve and document suspicious cases with Alert Guard	37
7.2.1	Alert Overview	37
7.2.2	Alert Guard Report	38
8	Offline Processing	40
8.1	On the FMD Speed Scanner	40
8.2	Further Processing in the Scan History	40
9	Maintaining the Lean FMD System	43
9.1	Renewal of a Certificate	43
9.1.1	securPharm	43
9.1.2	Arvato	44
9.2	Updating the Speed Scanner via F-Droid	45
9.2.1	Manual Software Updating	45
9.2.2	Automated Software Updating	47
9.2.3	Installation of test versions of the medAspis App	48
10	Attachments	52
10.1	Attachment: Icons	52
10.1.1	NMVS colours:	52
10.1.2	System colours:	52
10.2	Attachment: XML format for importing pack data	53

1 The System Design

The medAspis system is essentially a server solution on which the functions of the FMD examination run. The data is delivered to the system with Speed Scanners.

The Speed Scanners are Android handheld devices that are connected to the Internet via WLAN or mobile data. The handheld devices communicate with the server via this channel. To ensure data security, communications between the devices and the server are encrypted. The HTTPS protocol is used for this purpose. To further ensure security, customers will be given ports and URL upon request to configure the respective firewall.

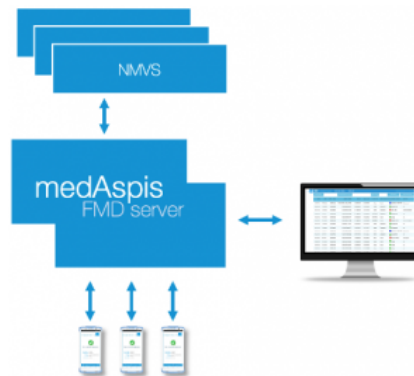

1.1 The basic design of the medAspis FMD system

As many handheld devices as required can be connected to the server. Communication between the devices is not necessary. Each device always communicates directly with the server.

The server is connected to the respective NMVS. Depending on the NMVS technology, different protocols are supported.

With the Control Panel, a portal is available to monitor and control the system.

2 The User Interface

The medAspis system uses mobile handheld scanners to scan medicine packs on site. The device is called Speed Scanner. The scan results can be reviewed and further processed via the Control Panel web portal. The system can be booked in different expansion stages. The full expansion stage is described here.

2.1 The Speed Scanner

The Speed Scanner is a commercially available Android smart device with a scanner unit. The application described here runs on this unit. This application can be updated via the F-Droid application. This update can be done automatically or manually.

2.1.1 The User Interface of the Speed Scanner

The user interface is divided into different fixed areas.

2.1.1.1 In the middle of the screen:

The captured information of the last scan together with a timestamp is centrally located. Above this you will find the result of the check by the responsible NMVS. If the system transmits the product name, it is displayed here. This product name may be truncated if the name is too long for one line. A symbol indicates whether the result was positive (green tick) or negative (red cross). The Solidsoft system issues a warning with a yellow icon. Other warnings – for example after scanning a barcode with the wrong format – come with a blue symbol. A list of all the symbols is to be found in the attachment.

2.1.1.2 The lower control line:

On the left, in the lower corner, is a counter. This counter counts all scanned packs but ignores duplicate scans of the same pack. Clicking on the number resets it to zero.

To the right of the counter is the FMD menu. With this menu, the FMD operation can be selected. The last FMD operation selected remains until a new operation is selected. For better usability, the designation of the selected FMD operation is displayed repeatedly in the upper left-hand corner

The half-right display shows whether the unit is currently connected to the medAspis FMD system via the Internet.

The three dots to the far right of it call up the settings for the application.

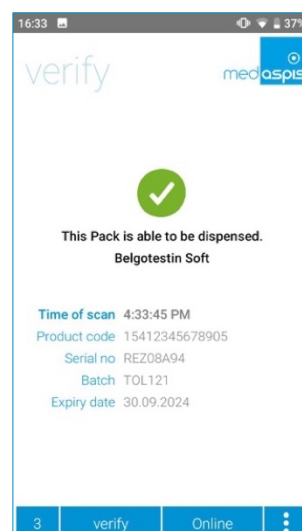

2.2 The Control Panel

The Control Panel is a web portal and is accessed via the address <https://panel.medaspis.org>. The Control Panel has a menu on the left side. By clicking on the three bars next to the medAspis logo, the menu can be folded away to make better use of the space on the screen. The Scan History is always displayed as the start screen. Other items in the menu are the scan archive and grouping (optional). The settings concern the organisation, the Speed Scanners used, access to the NMVS and a user administration for the Speed Scanners.

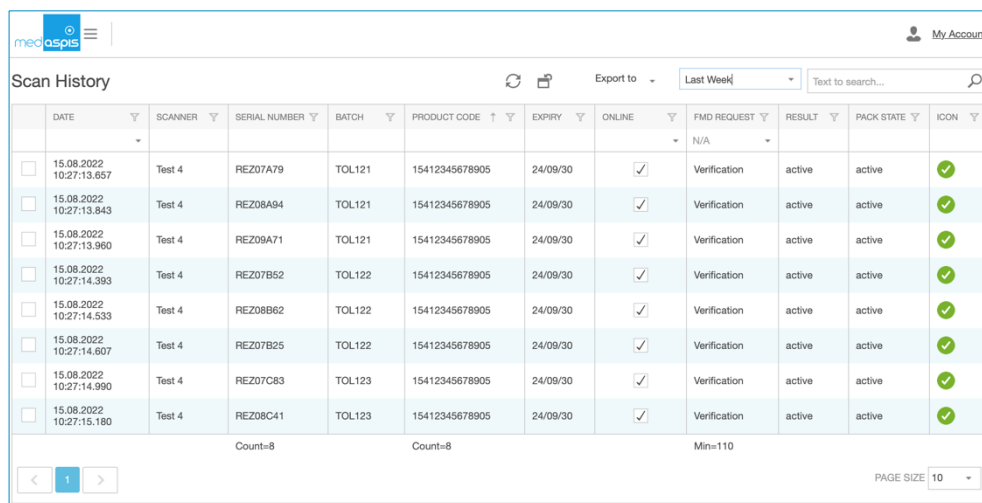

DATE	SCANNER	SERIAL NUMBER	BATCH	PRODUCT CODE	EXPIRY	ONLINE	FMD REQUEST	RESULT	PACK STATE	ICON
15.08.2022 10:27:13.657	Test 4	REZ07A79	TOL121	15412345678905	24/09/30	✓	Verification	active	active	✓
15.08.2022 10:27:13.843	Test 4	REZ08A94	TOL121	15412345678905	24/09/30	✓	Verification	active	active	✓
15.08.2022 10:27:13.960	Test 4	REZ09A71	TOL121	15412345678905	24/09/30	✓	Verification	active	active	✓
15.08.2022 10:27:14.393	Test 4	REZ07B52	TOL122	15412345678905	24/09/30	✓	Verification	active	active	✓
15.08.2022 10:27:14.533	Test 4	REZ08B62	TOL122	15412345678905	24/09/30	✓	Verification	active	active	✓
15.08.2022 10:27:14.607	Test 4	REZ07B25	TOL122	15412345678905	24/09/30	✓	Verification	active	active	✓
15.08.2022 10:27:14.990	Test 4	REZ07C83	TOL123	15412345678905	24/09/30	✓	Verification	active	active	✓
15.08.2022 10:27:15.180	Test 4	REZ08C41	TOL123	15412345678905	24/09/30	✓	Verification	active	active	✓

Count=8 Count=8 Min=110

PAGE SIZE 10

3 Setting up the System

3.1 A new account

For every new customer an account is provided by medAspis. Initially, a temporary password is issued, which can be changed to a personal password the first time it is used.

3.2 Log on to the system

The medAspis system can be reached at <https://panel.medaspis.org>. A login field appears where account name and password can be entered.

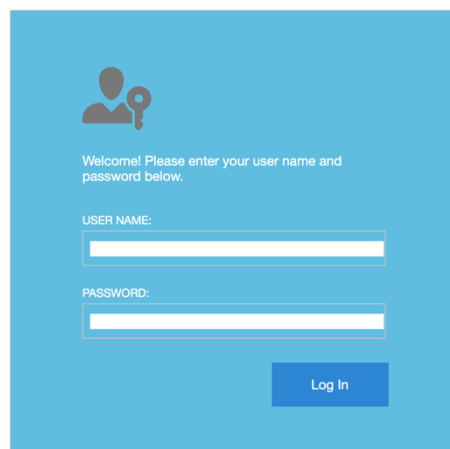

3.2.1 Password complexity

The password must not be too simple, it must be subject to a certain complexity. It is up to the user how to achieve this complexity. Basically, the following factors are included in the complexity calculation of the password:

- Password length
- Use of upper and lower case
- Use of special characters
- Use of digits

There is no rule that prescribes to use all the complexity elements mentioned above. A password can be complex enough if you do not use special characters, but the length of the password already forms a sufficient complexity.

3.3 Manage your own account

By clicking on the 'My Account' link in the top right-hand corner, you can log out of the system or set a few basic parameters for the system.

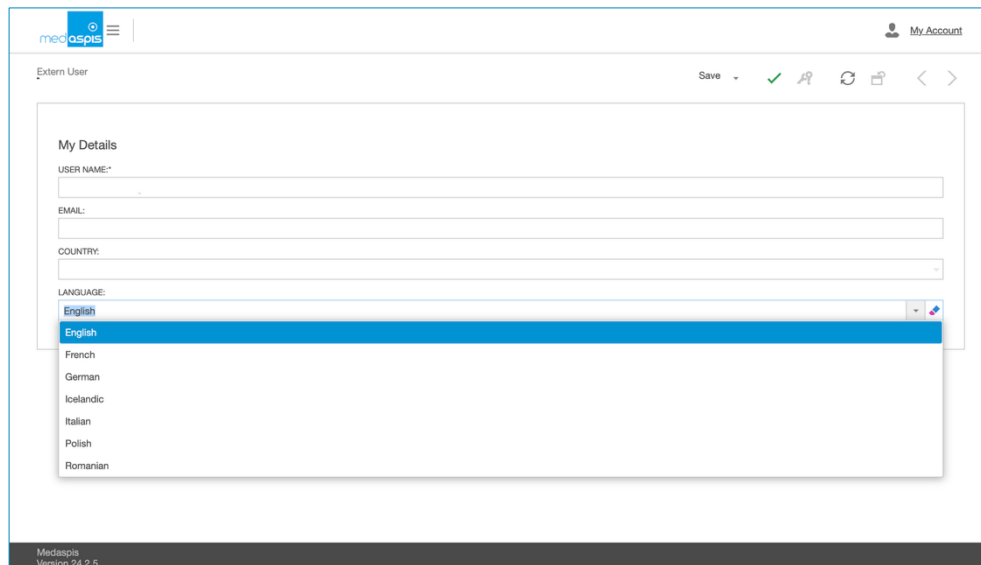

The user name and country cannot be changed. However, the contact email address and system language can be adjusted in this view.

3.4 Complete organisation

After entering this data, the control panel opens and further data of the organisation is requested. These are the name and address as well as a responsible person for further communication. This completes the registration process.

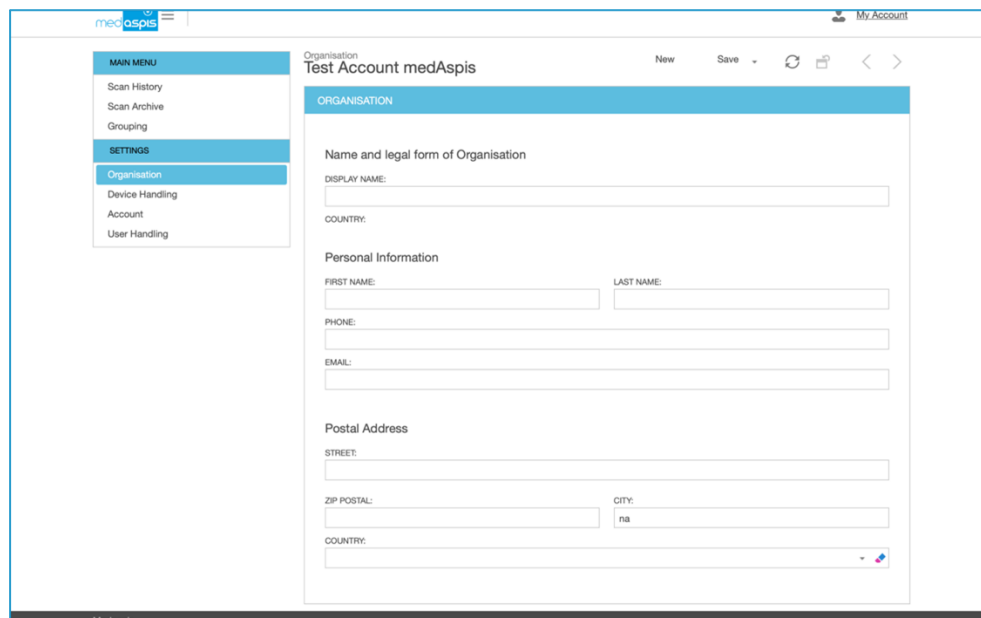

3.5 Setting up a Speed Scanner (server side)

Each Speed Scanner used must be logged into the customer account. To do this, a new device must be registered in the Control Panel under the menu item "Device Handling".

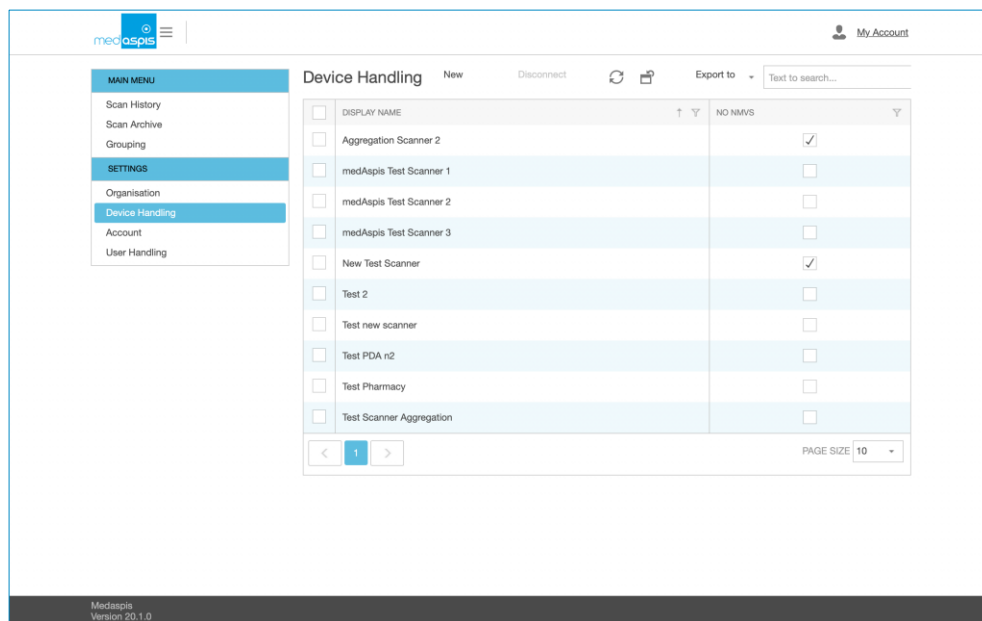

After opening the window, you can see all the scanners that have been registered so far. The scanners are displayed with their name and the parameter "No NMVS".

With the button "New" a new scanner can be registered.

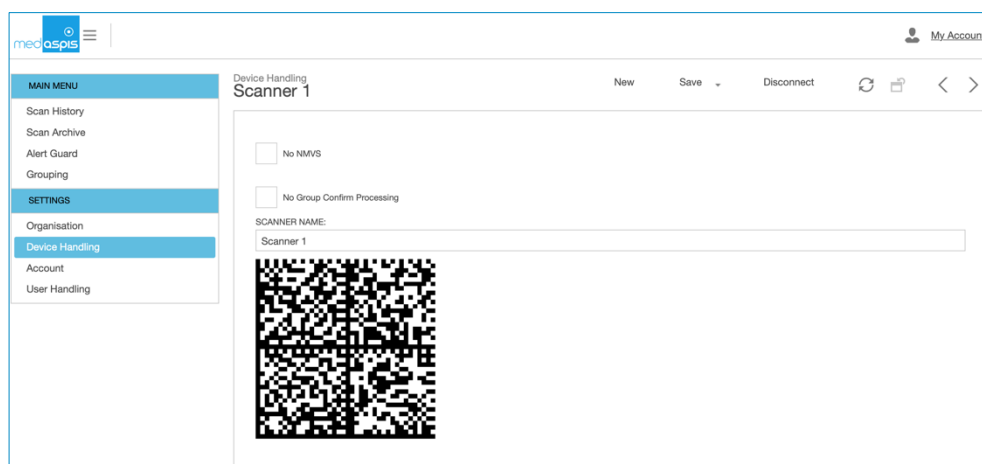

Two fields must be specified for the new scanner:

NAME: The name of the scanner. This name is later visible in the Settings menu of the scanner and the scans appear under this name in the Scan History.

NO NMVS: If this value is clicked, the scanned data is not transmitted to the NMVS. Customers use this setting to read 2D matrix codes, but not to evaluate them via the NMVS.

No Group Confirm Processing Normally, once a group has been closed, no more packs can be added. Activating this function drops this restriction. Groupings can be extended at any time.

The process is completed with the “Save” button. A large enrolment code appears on the screen. This must be read in by the Speed Scanner to be connected in the enrolment process in order to connect it to your own system.

Each scanner can be logged in and out of the system as required. To disconnect the scanner from the control panel, use the “Disconnect” button. New registrations are always made by entering a scanner in the scanner list of the menu item “Device Handling”.

Once a scanner has been created, it cannot be deleted. This ensures that it is always possible to determine which data was read in with which scanner (data integrity, audit trail).

3.6 Setting up a Speed Scanner (device)

If the scanner is not in enrolment mode, please go to the application settings and click five times on the medAspis logo. The application immediately starts the teach-in process.

The scanner now scans the enrolment code from the control panel. If the scanner cannot detect the code due to possible reflections of the computer display, the “Scan” button on the Speed Scanner display can be activated. A new window opens and the enrolment code can be captured from the screen with the Speed Scanner’s built-in camera.

After a second confirmation screen, a Congratulations screen appears and the Speed Scanner is connected to the system.

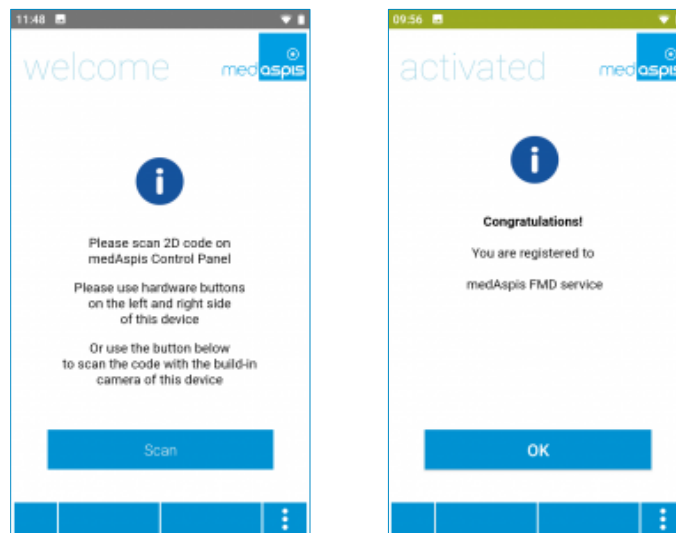

3.7 Register at NMVS

The system must be connected to the responsible NMVS in order to be able to perform the FMD tasks. Three different systems are in use in Europe. medAspis has the capability to connect to all three systems (securPharm, Arvato, SolidSoft). The necessary steps for registration are carried out in the menu item “Device Handling”. Different registration steps are required for each of the three systems.

3.7.1 Access to the Arvato system

This system is used in Austria, Belgium, Cyprus, Estonia, Finland, France, Hungary, Latvia, Luxembourg, Malta, the Netherlands, Norway, Poland, Portugal, Romania, Slovenia, Spain and the United Kingdom (Northern Ireland).

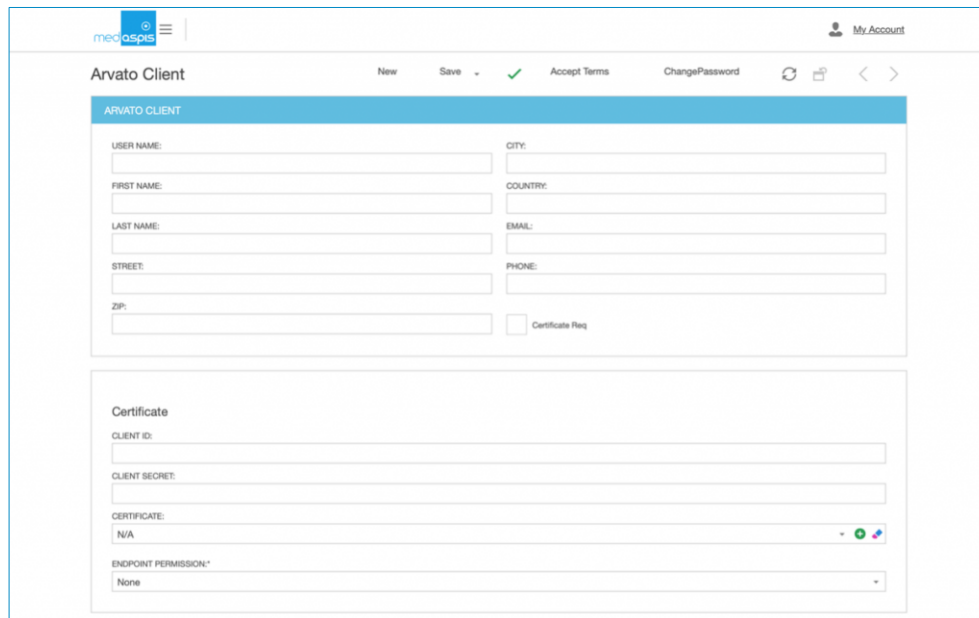

Before this process step can be performed, the user has to be registered with his responsible NMVS and received the access data to be entered here. First, all user data is entered and then the username and initial password received from the NMVO are entered in the "Certificate" section.

The certificate is then downloaded. First, the certificate window must be opened by clicking the "plus" symbol.

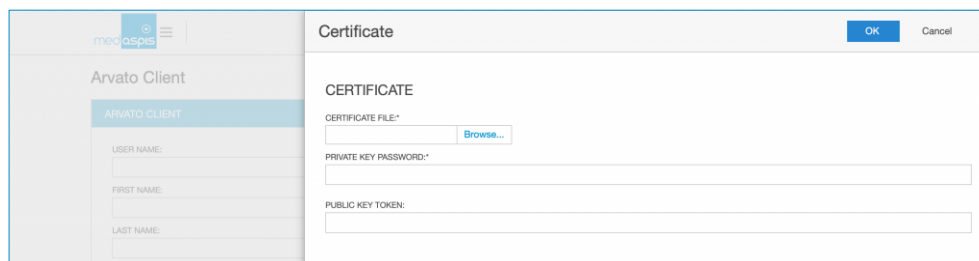

The certificate file (p.12) previously provided by the NMVO is uploaded and the certificate password and password token are entered. Both data are provided by the NMVS. The certificate window is closed with OK and the entire process is completed with "Save".

Afterwards, the Arvato Terms and Conditions are confirmed in the Arvato main window and the initial password is changed. Buttons are available for both processes in the upper part of the window.

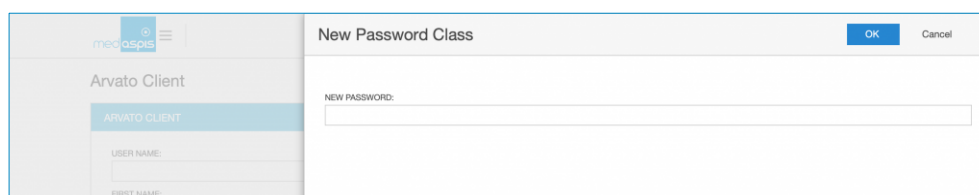

The new password is confirmed with OK. The password window closes.

The process is completed, the system is connected to the responsible NMVS.

3.7.2 Access to the Solidsoft system

This system is in use in Bulgaria, Denmark, Ireland, Iceland, Croatia, Liechtenstein, Lithuania, Sweden, Switzerland, Slovakia and the Czech Republic.

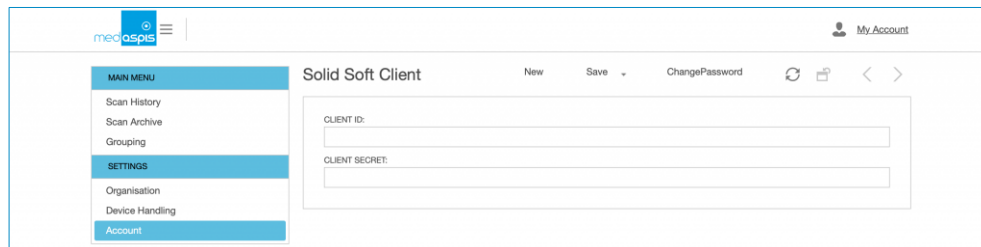

Before this process step can be performed, the user has to be registered with his responsible NMVS and received the access data to be entered here. The "Client ID" and the "Client Secret" are entered and saved with the "Save" button.

The process is completed, the system is connected to the responsible NMVS.

3.7.3 Access to the securPharm system

This system is only used in Germany.

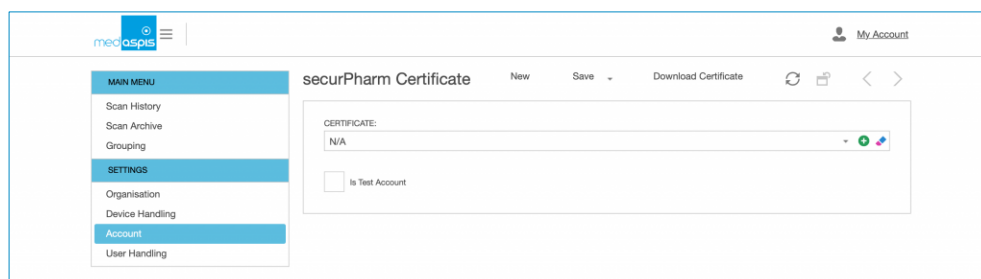

First, the button "Download Certificate" opens a new window in which the securPharm certificate can be loaded. To download the certificate, the customer has received a so-called company number N-ID (format APOxxxxxx) and a password from NMVO. These two values are entered in the fields provided and acknowledged with "OK" at the top of the window.

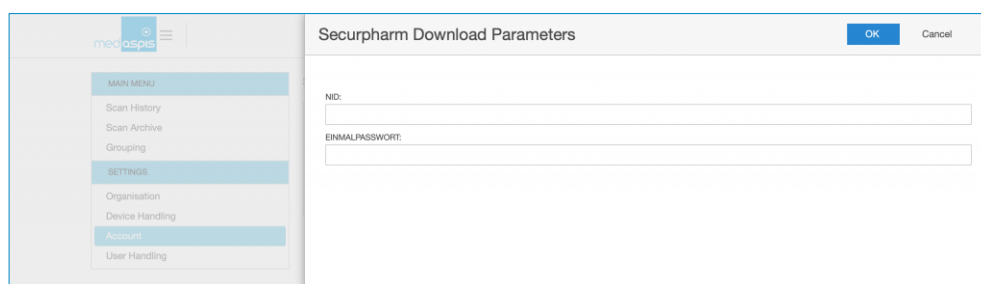

The window closes again and the certificate downloaded from the NMVS in the meantime is displayed. Now the process must be saved in the securPharm main window by clicking the "Save" button at the top of the window.

3.7.3.1 Alternative registration

If you have already downloaded your certificate from NGDA yourself, you will have a file with your company number as "Name and. p12" as suffix (APOxxxx.p12).

Please click on the green plus at the input field "Certificate" first. A new window opens:

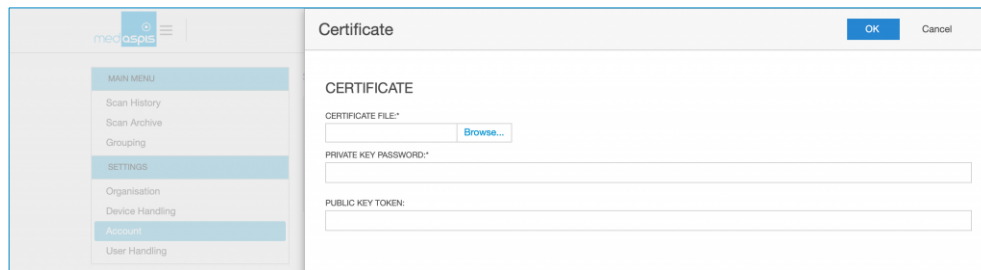

In this window the certificate can be uploaded, the corresponding password must be entered, the “PUBLIC KEY TOKEN” must remain empty.

The process is completed, the system is connected to securPharm.

3.8 User login to the Speed Scanner

Optionally, the users of the Speed Scanners can be entered. Each time the users scan packs, the specified username is saved to that scan. The names can be displayed in the Scan History.

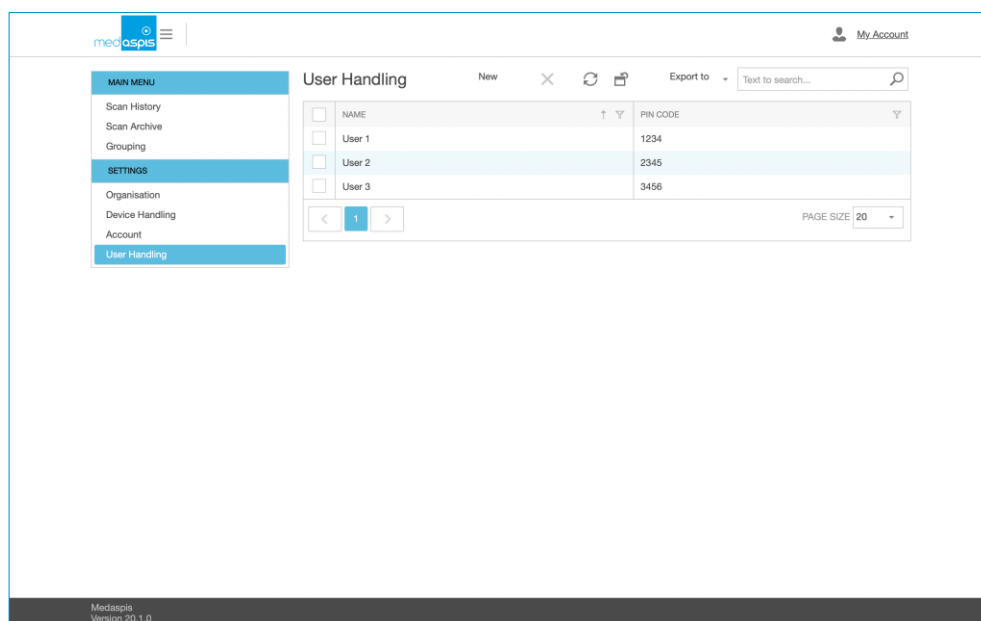

With the button “New” a new user can be created.

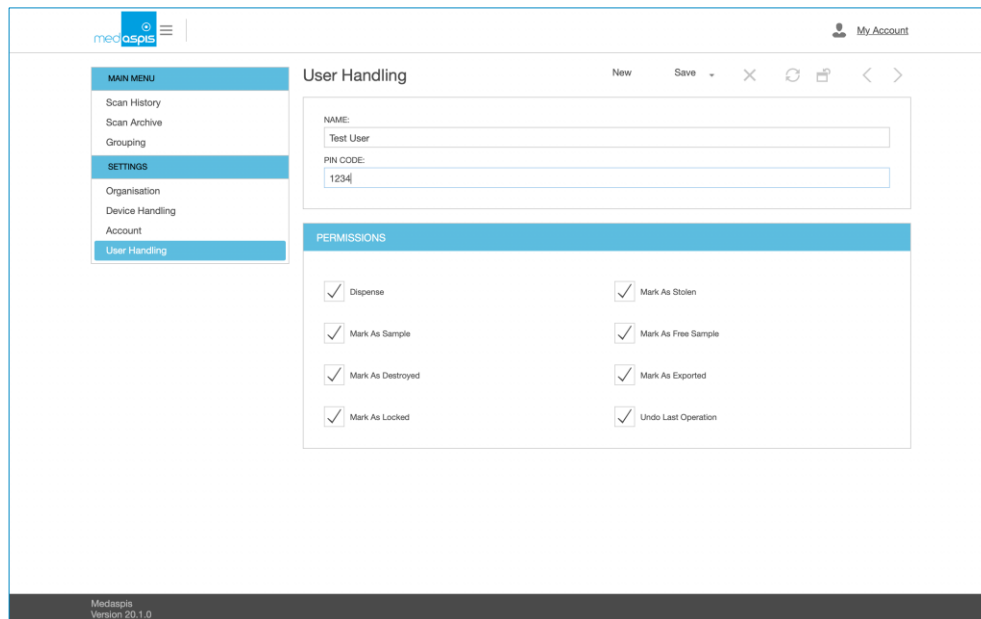

For this purpose, the username and a numeric (digit) password of any length are entered. The username appears in the “User” field in the Settings of the Speed Scanner and in the Scan History. The password is requested in the handheld device as an identity check. In addition, the permitted FMD operations can be restricted for each user.

After completion, the entries are saved with “Save”.

User management is an identity control and thus a measure for organising operations. User management is not a function in the sense of system security.

3.8.1.1 Access rights

Individual usage rights can be assigned for each user. The FMD operations allowed in the “Permissions” field are displayed in the FMD menu of the hand-held scanner, the others are not offered.

3.8.1.2 In use on the Speed Scanner

A user can only use the Speed Scanner if he has entered the correct password beforehand.

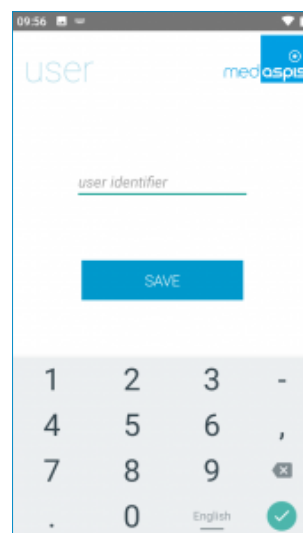

3.9 First steps

Switch on the Speed Scanner and open the “Connector+” application.

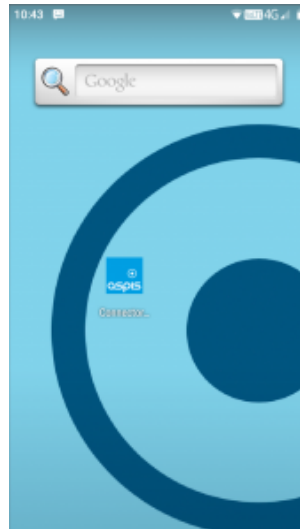

Switch on the Speed Scanner and open the “Connector+” application. You already know the unit and the application from the introduction.

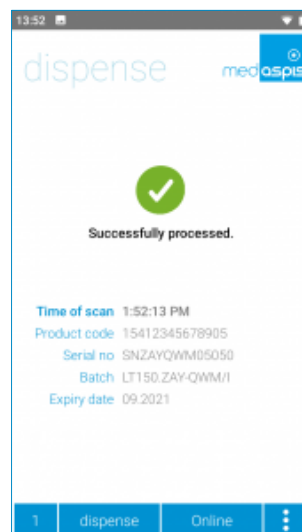

Important:

If you receive a warning or an unclear message after the first scan: Please stop your first attempt and contact us immediately. It is possible that one of the credentials (user ID, password, certificate password) is incorrect. If you scan more than 5 times, your NMVS account may be blocked.

If no warnings are displayed, go to the main menu and click on the Scan History again. On this page you can see all the scans and the corresponding response from the NMVS.

Congratulations - you are now FMD compliant!

4 The Speed Scanner

The user will select the FMD option in the FMD menu of the FMD Speed Scanner application and scan the 2D Matrix Code. The information will be transferred to the NMVS and from there back to the FMD Speed Scanner. The data received from the NMVS is displayed on the screen.

In case the result is positive, the user will scan the next code. In case the result is negative the user must confirm the alert which is displayed on the screen of the FMD Speed Scanner. In both cases the scan data and the FMD result is visible in the Scan History of the Control Panel. In case of a negative result, the user confirmation is registered in the Control Panel as well.

The data can be processed further in the Control Panel. The most important function is the visualisation of the scan data. These can be filtered and exported almost as required.

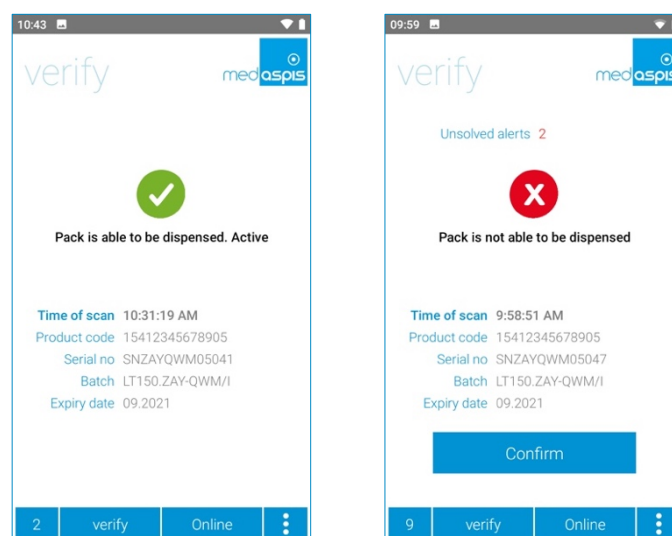

4.1 Working with the Speed Scanner

First, the required FMD operation is selected via the FMD menu on the Speed Scanner. If no selection is made, the default operation is "verify".

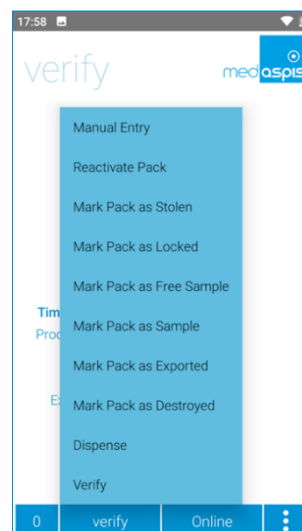

4.1.1 Available FMD Operations

All FMD operations provided by the NMVO are applicable in the medAspis system. Some of the operations are locked for pharmacies. However, they are still displayed in the menu. If a non-permitted operation is performed, an error message is returned by the NMVS.

Menu option	wholesale	pharmacy
verify	x	x
dispense	x	x
mark pack as destroyed	x	x
mark pack as exported	x	-
mark pack as sample	x	x
mark pack as free sample	x	-
mark pack as locked	x	-
mark pack as stolen	x	x
reactivate pack	x	x

4.2 Transfer the recorded code to the NMVS

The Speed Scanner immediately sends all captured records to the medAspis FMD server. Here the code is prepared and sent for processing to the NMVS. As soon as the result is sent back, the response is forwarded to the Speed Scanner.

4.2.1 Scan a 2D matrix code

The Speed Scanner captures a 2D matrix code from a medicine box and processes the captured data stream. If the scanned code does not correspond to the expected syntax in GS1 coding or PPN coding (only available in Germany), the scanning process is aborted and the message "NO FMD" is displayed. The scan attempt is also displayed in the Scan History with the same result.

4.2.2 Scan Accelerator

The Speed Scanner is able to scan faster than the NMVS can process the codes. Only one request can be made to the NMVS at a time. The unprocessed requests from the Speed Scanner go into a queue if the NMVS is slower than the Speed Scanner sends requests.

The number of records in the queue is displayed on the Speed Scanner. With fast scanning and slow NMVS, with technically undisturbed operation, up to 5 packs can be expected in the queue.

4.2.3 Processing of NMVS Response

Both the Unique Identifier scanned by the 2D Matrix Code and the data set returned by the NMVS are stored completely in the data structure of the medAspis FMD system. The result is analysed and interpreted. The corresponding result is shown in the Speed Scanner display and saved in the Scan History.

4.2.4 Batch Control

The Batch Control option can be switched on in the settings of the Speed Scanner. The Speed Scanner gives a warning if a batch or product code is scanned differently from a reference pack.

The reference pack is determined by the first scan after a counter reset in the Speed Scanner screen at the bottom left.

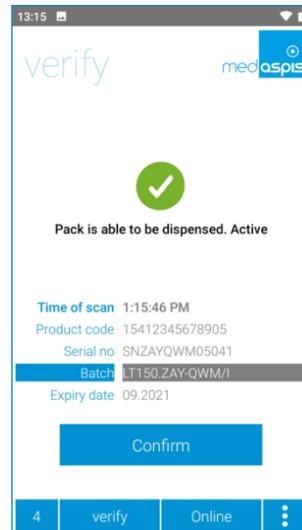

4.2.5 Data collection only

Packs can also be captured without the data records being automatically forwarded to the responsible NMVS. To make this state clearer, the symbol is displayed in blue.

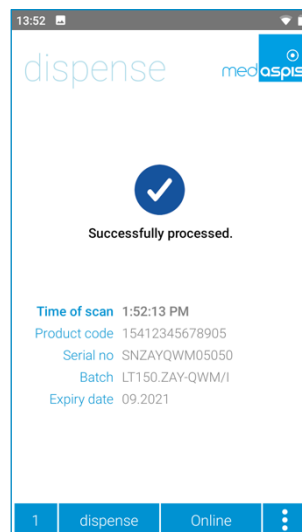

4.2.6 Reading Crypto Codes

In addition to processing FMD codes, the hand-held device is also able to read Crypto Codes. These Crypto Codes are common in Russia, and countries such as Kazakhstan also use this type of code.

Attention: The medAspis Lean FMD system cannot verify Crypto Codes, it can only read them.

4.3 Performing FMD Operations

This section describes the main states the system can have when processing FMD operations. Similar functions are described only once. “exported”, “stolen”, “sample”, “free sample”, “locked”, “destroyed” are analogue to “dispense”. In this description, “dispense” is explained in detail, the subtypes work similar.

4.3.1 Verify

The FMD mode of the Speed Scanner is set to “verify”. The 2D matrix code of a pack is scanned. A “Verify” command is sent to the responsible NMVS.

A pack can be verified as often as required. A separate line appears in the Scan History for each “Verify” command. Packs with the same serial number can be scanned as often as required and each will be found in the Scan History.

The result of a “Verify” check can be negative.

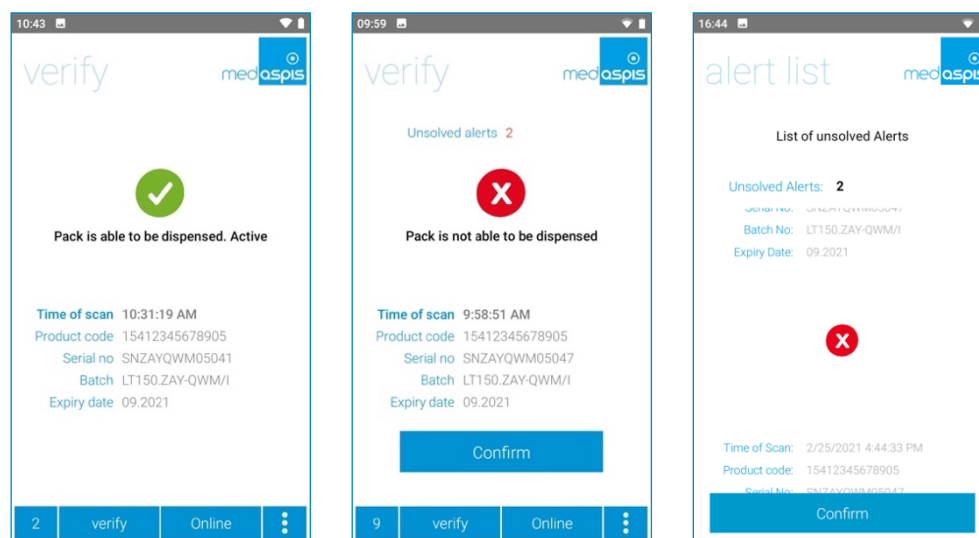

In this case, the scanner is stopped, you can no longer scan, you have to take care of the alert. This process is documented by clicking the “Confirm” button on the Speed Scanner display. Analogously, this is noted in the Scan History.

In addition, the packs concerned are secured in the Speed Scanner. The packs can be checked in the alert list. When the errors are acknowledged, the “unsolved alert” counter is reset to zero.

4.3.2 Dispense

The FMD mode of the Speed Scanner is set to “dispense”. The 2D matrix code of a pack is scanned. A „Dispense” command is sent to the responsible NMVS. The result can be positive or negative, just like “verify” and all other FMD operations.

The command “dispense” sets the status of the pack from “active” to “inactive”. A pack that is set “inactive” cannot be dispensed again.

A separate line appears in the Scan History for each Dispense command.

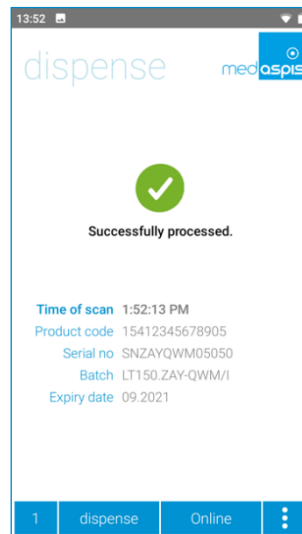

4.3.3 Double Dispense

Redispending an already inactive pack will result in an NMVS error. This error may occur very often because packs are dispensed several times due to carelessness.

Under certain conditions, the medAspis system recognises a dispensing as a duplicate and does not send it again to the NMVS. Instead, the result of the previous dispense is displayed again, but with the "Double Dispense" icon. The same response is also displayed in the Scan History, again with the Double Dispense icon.

The condition for detecting a double is that the same pack has been deactivated with the same FMD command within the last 10 minutes.

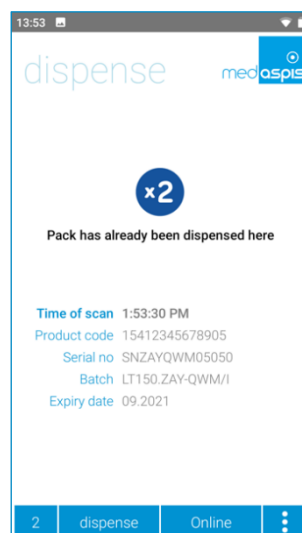

4.3.4 Double Dispense Filter is switched off in certain situations

The Double Dispense Filter does not send the same FMD operation (Disable, Export, Stolen, Destroy, Probe, etc.) to the NMVS for rechecking for a set period of time (10 minutes in the default or two hours in Alert Guard).

However, there are results for which this time delay is a disadvantage. For example, if the NMVS system is unavailable for a short time, the double-dispense filter is turned off and another FMD operation is possible immediately.

The double-dispense filter is also switched off for login operations (login, password entry, etc.).

4.3.5 Reactivate

The FMD menu of the Speed Scanner is set to "reactivate". The 2D matrix code of a pack is scanned. A reactivation command is sent to the responsible NMVS. It is not necessary to specify the original FMD operation to be reset now. This attribute, which is necessary for the NMVS, is automatically added to the reactivation command by medAspis system.

Excluded from this are the statuses "marked as stolen" and "marked as destroyed". The NMVS system don't allow to reactivate those statuses.

Reactivation resets the status of the pack from "inactive" to "active". For various reasons, this operation can be negatively acknowledged. Then an error message appears.

The reactivation is displayed as a separate line in the Scan History.

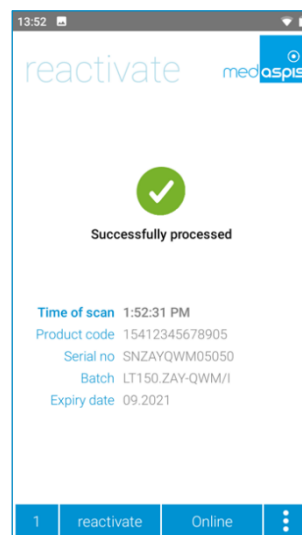

4.3.6 Manual Entry

If a 2D matrix code cannot be scanned by the scanner, the data can be entered manually. To do this, the predefined fields must be filled in and the required FMD operation must be specified.

If an expiry date has only year and month, the day in the display is either left blank or filled with 0 (zero).

The NMVS response appears again on the main screen of the FMD Speed Scanner.

In the Scan History, the manual display is not specially marked. The FMD command resulting from the manual input is displayed exactly as if it had been generated by the scanner.

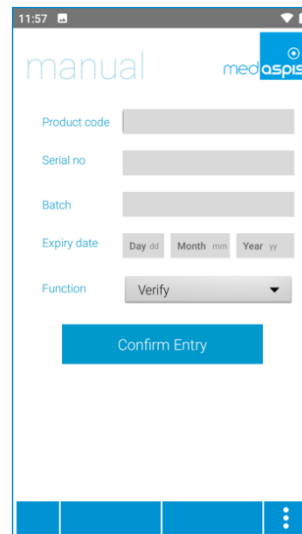

4.3.7 Offline Mode

A permanent internet connection from the hand-held device to the medAspis server is necessary for the unrestricted function of the Lean FMD system. All scanned data records are immediately sent from the handheld device to the server, where further processing takes place.

If the internet fails, this processing is disrupted. There are many reasons for a broken connection: The handheld scanner or the server are not working correctly, a malfunction at the internet provider, technical faults or changed settings in the local wi-fi router.

In such cases, the hand-held device indicates the loss of the Internet connection and records all data sets. The offline status and the number of data records temporarily stored in the device are displayed in the field at the bottom right.

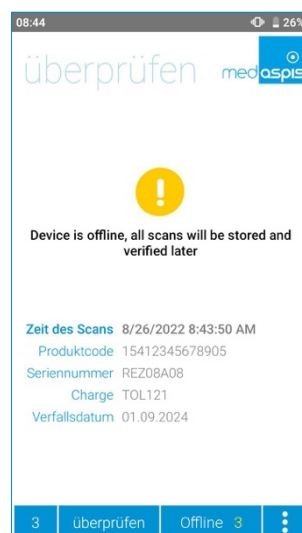

As soon as the Internet connection is re-established, all stored data sets are automatically transferred to the server.

ATTENTION: The data is not processed on the server immediately. Manual intervention is required to perform the originally desired FMD operations.

4.4 The Speed Scanners settings

Various settings can be made on the Speed Scanner.

The light blue box contains information about the account, the scanner name and the current user of the device.

The three switches below control the scanner unit. You can switch the sound and vibration on and off separately. In continuous mode, the scanner is switched on permanently using the side buttons or the pistol grip. 2D matrix codes are now continuously captured until the scanner is manually switched off again. If the continuous mode is switched off, 2D Matrix Code can only be scanned one at a time.

“Log Out User” logs out the current user. You have to register again for the next service.

“Enter Grouping” forces the entry of a new grouping.

“Batch Control” switches on the automatic batch control.

“Grouping” switches on the grouping function.

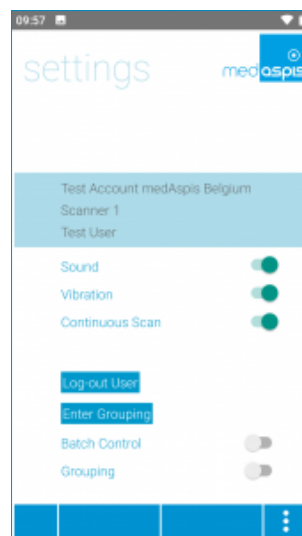

5.1.1 Sort data

Sorting each individual column of the Scan History table is possible by clicking on the respective column header. The sorting is indicated by an arrow symbol to the right of the column title. Clicking again reverses the sort order.

The default setting is sorting by date. The most recent entry is displayed at the top.

5.1.2 General filters

The data sets can be filtered as required, all filters can be combined. Each column has a funnel symbol next to the heading. By clicking on the funnel symbol, a window is displayed with which a filtering of the corresponding column can be carried out.

The date can be narrowed down with start and end date. A specific serial number can be filtered, a specific expiry date, a specific pack status, etc.

Set filters can be deleted by clicking on the "Clear" function at the bottom right of the screen.

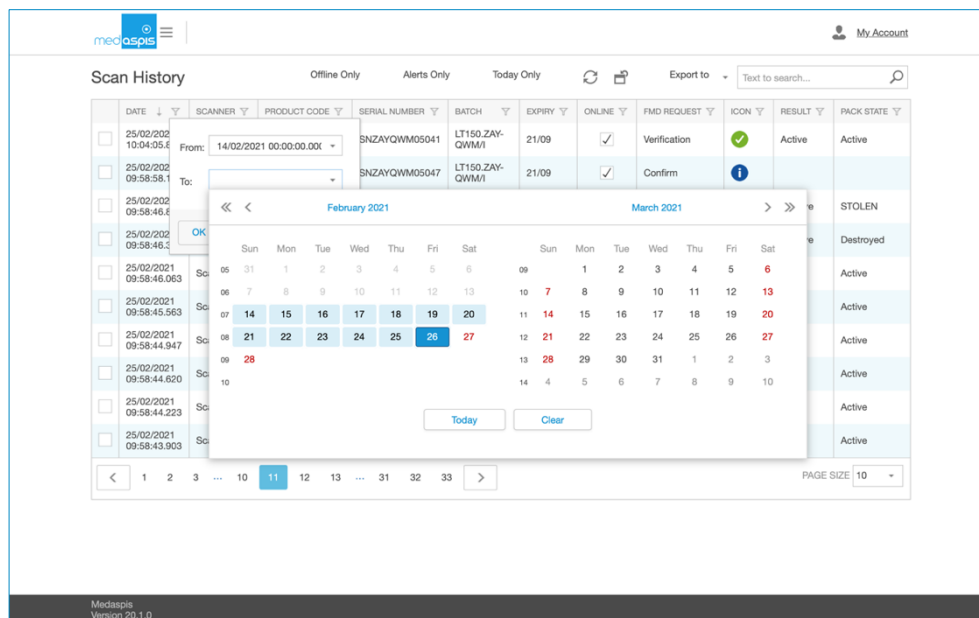

5.1.3 Search functions in the table

Directly under the table headings, you will find a direct search function for most columns. In the case of predefined column contents, the contents can be selected directly via an expanding context menu.

Combinations of filters in different columns are possible. The selected search filters are summarised in text form in the sub-line and can be completely cleared again at any time by clicking on the word "clear".

Attention: Only those columns can be searched, sorted or filtered for which this option has a practical use. Otherwise, the column search is not available.

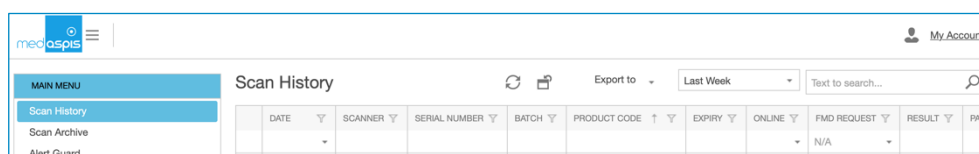

5.1.4 Export data

The selected and filtered data can be exported. All displayed parameters (displayed columns) and entries (displayed rows) can be exported from the system to CSV, XLS, XLSX and pdf formats. The data is provided via the download function of the browser.

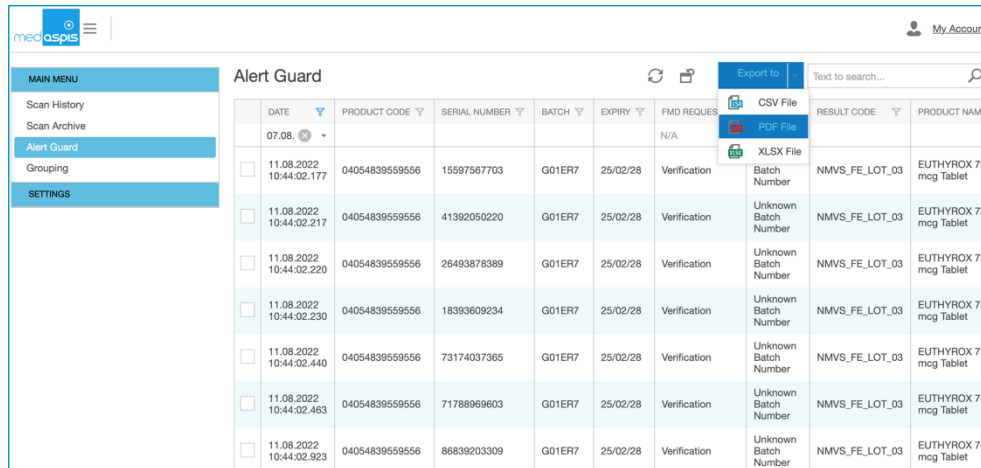

DATE	PRODUCT CODE	SERIAL NUMBER	BATCH	EXPIRY	FMD REQUEST	FMD REQUEST	RESULT CODE	PRODUCT NAME
07.08.					N/A			
11.08.2022 10:44:02.177	04054839559556	15997567703	G01ER7	25/02/28	Verification	Batch Number	NMVS_FE_LOT_03	EUTHYROX 75 mg Tablet
11.08.2022 10:44:02.217	04054839559556	41392050220	G01ER7	25/02/28	Verification	Unknown Batch Number	NMVS_FE_LOT_03	EUTHYROX 75 mg Tablet
11.08.2022 10:44:02.220	04054839559556	26493878389	G01ER7	25/02/28	Verification	Unknown Batch Number	NMVS_FE_LOT_03	EUTHYROX 75 mg Tablet
11.08.2022 10:44:02.230	04054839559556	18393609234	G01ER7	25/02/28	Verification	Unknown Batch Number	NMVS_FE_LOT_03	EUTHYROX 75 mg Tablet
11.08.2022 10:44:02.440	04054839559556	73174037365	G01ER7	25/02/28	Verification	Unknown Batch Number	NMVS_FE_LOT_03	EUTHYROX 75 mg Tablet
11.08.2022 10:44:02.463	04054839559556	71788969603	G01ER7	25/02/28	Verification	Unknown Batch Number	NMVS_FE_LOT_03	EUTHYROX 75 mg Tablet
11.08.2022 10:44:02.923	04054839559556	86839203309	G01ER7	25/02/28	Verification	Unknown Batch Number	NMVS_FE_LOT_03	EUTHYROX 75 mg Tablet

If the number of records to be downloaded exceeds the technical capacity of the system, the export will not be carried out; instead, a short note will appear with the corresponding information.

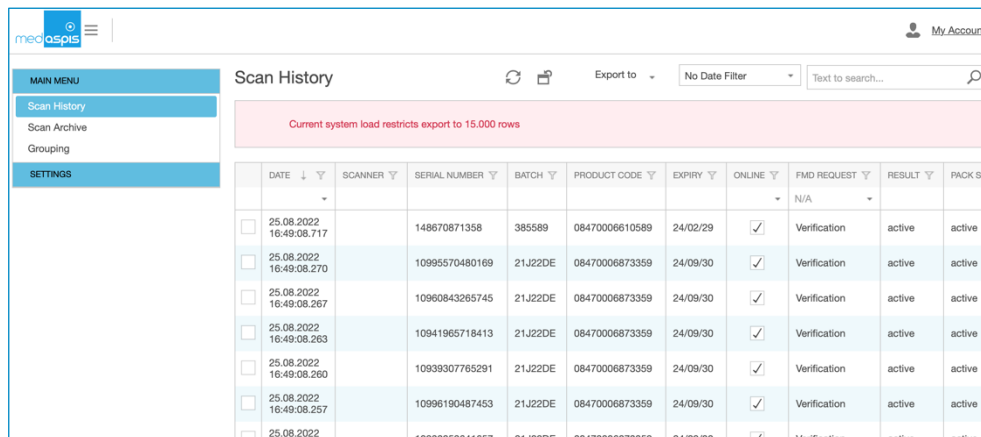

DATE	SCANNER	SERIAL NUMBER	BATCH	PRODUCT CODE	EXPIRY	ONLINE	FMD REQUEST	RESULT	PACK STZ
25.08.2022 16:49:08.717		148670871358	385589	08470006610589	24/02/29	✓	Verification	active	active
25.08.2022 16:49:08.270		10995570480169	21J22DE	08470006873359	24/09/30	✓	Verification	active	active
25.08.2022 16:49:08.267		10960843265745	21J22DE	08470006873359	24/09/30	✓	Verification	active	active
25.08.2022 16:49:08.263		10941965718413	21J22DE	08470006873359	24/09/30	✓	Verification	active	active
25.08.2022 16:49:08.260		10939307765291	21J22DE	08470006873359	24/09/30	✓	Verification	active	active
25.08.2022 16:49:08.257		10996190487453	21J22DE	08470006873359	24/09/30	✓	Verification	active	active
25.08.2022		10932253641657	21J22DE	08470006873359	24/09/30	✓	Verification	active	active

5.1.5 Display of additional Information

All additional information can be displayed for each individual scan by clicking on the respective line.

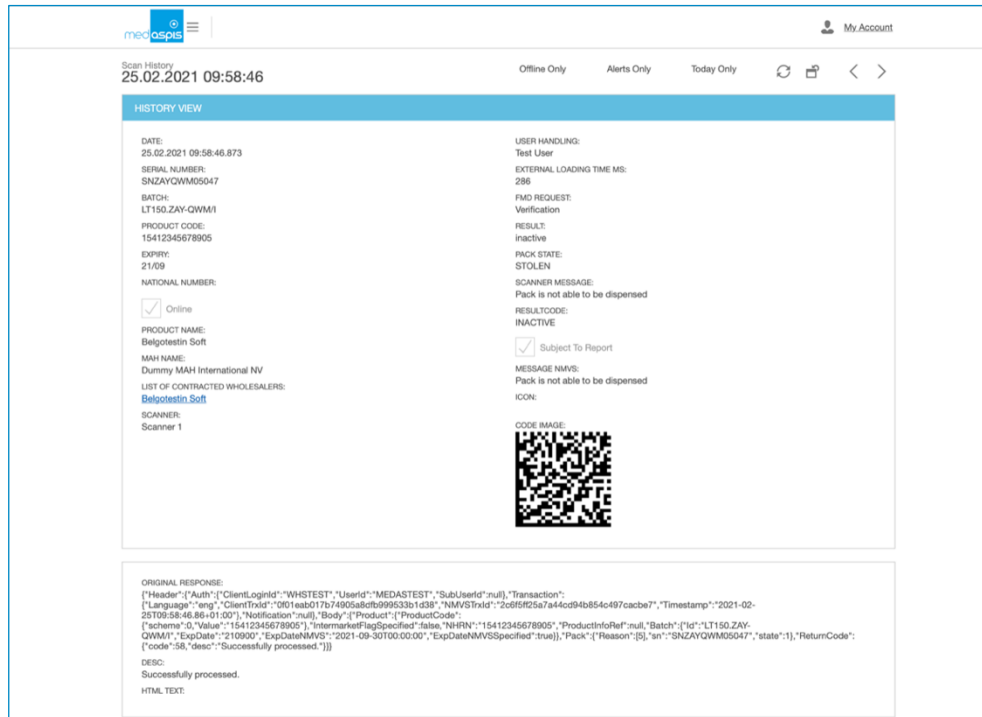

HISTORY VIEW

DATE: 25.02.2021 09:58:46.873

SERIAL NUMBER: SNZAYQWM05047

BATCH: LT150.ZAY-QWM1

PRODUCT CODE: 15412345678905

EXPIRY: 21/09

NATIONAL NUMBER:

USER HANDLING: Test User

EXTERNAL LOADING TIME MS: 286

FMD REQUEST: Verification

RESULT: Inactive

PACK STATE: STOLEN

SCANNER MESSAGE: Pack is not able to be dispensed

RESULT CODE: INACTIVE

CODE IMAGE:



ORIGINAL RESPONSE:

```
[{"Header":{"Auth":{"ClientLoginId":"WHSTEST","UserId":"MEDASTEST","SubUserId":null},"Transaction":{"Language":"eng","ClientTrxid":"001eab017b74905a8c9b99533b1d38","NMVSTrxid":"2c6f5f25a7a44cd94b854c497cacbe7","Timestamp":"2021-02-25T09:58:46.86-01:00"},"Notification":null},"Body":{"Product":{"ProductCode":{"scheme":"0","Value":"15412345678905"},"IntermarketFlagSpecified":{"date":{"NRN":"15412345678905"},"ProductInfoRef":null,"Batch":{"lt":"LT150.ZAY-QWM1"},"ExpDate":{"Z10900":{"ExpDateNMVST":"2021-09-30T00:00:00","ExpDateNMVSSpecified":true},"Pack":{"Reason":{"S":"SNZAYQWM05047"},"state":1},"ReturnCode":{"code":"56","descr":"Successfully processed."}}}}}}]
```

HTML TEXT:

5.1.6 Offline Mode

If the handheld device does not have a direct Internet connection during operation, the data is temporarily stored for this time and immediately uploaded to the server as soon as the Internet connection is available again.

The data is displayed in the scan history and marked as offline (not online). With the filter functionality of the table column, all offline scans can be found and displayed immediately.

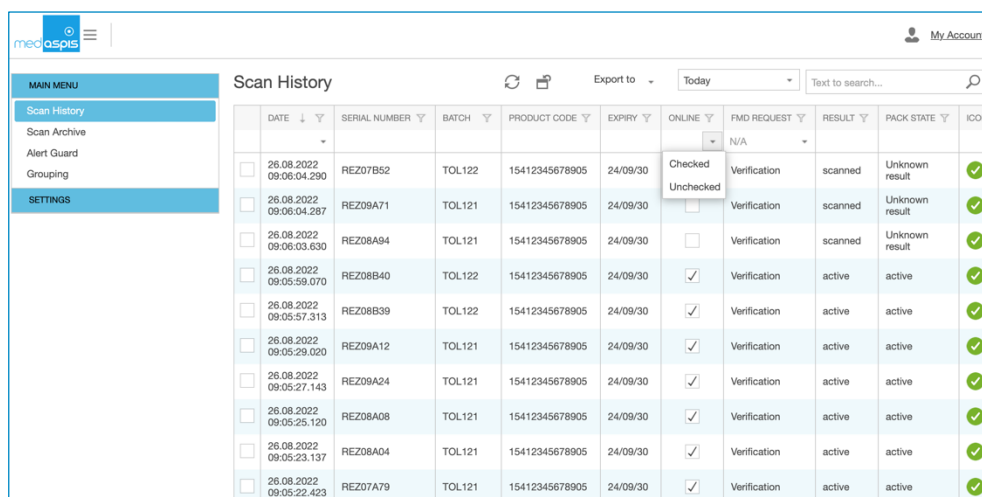

DATE	SERIAL NUMBER	BATCH	PRODUCT CODE	EXPIRY	ONLINE	FMD REQUEST	RESULT	PACK STATE	ICON
26.08.2022 09:06:04.290	REZ07B52	TOL122	15412345678905	24/09/30	Checked	Verification	scanned	Unknown result	✓
26.08.2022 09:06:04.287	REZ09A71	TOL121	15412345678905	24/09/30	Unchecked	Verification	scanned	Unknown result	✓
26.08.2022 09:06:03.630	REZ08A94	TOL121	15412345678905	24/09/30		Verification	scanned	Unknown result	✓
26.08.2022 09:05:59.070	REZ08B40	TOL122	15412345678905	24/09/30	✓	Verification	active	active	✓
26.08.2022 09:05:57.313	REZ08B39	TOL122	15412345678905	24/09/30	✓	Verification	active	active	✓
26.08.2022 09:05:29.020	REZ09A12	TOL121	15412345678905	24/09/30	✓	Verification	active	active	✓
26.08.2022 09:05:27.143	REZ09A24	TOL121	15412345678905	24/09/30	✓	Verification	active	active	✓
26.08.2022 09:05:25.120	REZ08A08	TOL121	15412345678905	24/09/30	✓	Verification	active	active	✓
26.08.2022 09:05:23.137	REZ08A04	TOL121	15412345678905	24/09/30	✓	Verification	active	active	✓
26.08.2022 09:05:22.423	REZ07A79	TOL121	15412345678905	24/09/30	✓	Verification	active	active	✓

It is not known to the system whether these offline scans should be sent to the NMVS or not. Only the user knows if another scan has been made in the meantime or if the offline scan was made so long ago that it has been obsolete in the meantime.

For this reason, the entries marked as offline in the scan history must be activated individually and manually. To do this, click on the relevant line and scan the 2D matrix code with a hand scanner. With this information, the content concerned can be processed. The scan creates a new entry in the scan history.

If there are several offline entries to be processed, you can easily switch to the next entry in the detail view by clicking the next button. If the offline filter was previously activated, only offline scans are included in the detail views.

5.1.7 The context menu

The context menu can be opened by clicking the right mouse button on the table heading.

The following functions can be started:

Sort Ascending, Sort Descending: The selected column can be displayed sorted.

Hide Column: The selected column is removed from the table.

Column Chooser: An additional menu is displayed on the right side of the page. All columns are listed that can be displayed in addition to the existing overview. To activate one of these columns, move the desired column title from the displayed list with the mouse and insert it into the table at the desired position. The table will then always appear in this modified view.

Filter Row: With this function the search field of the columns can be shown or hidden.

Footer: An additional blank line is displayed below the displayed rows. In this line, another context menu can be activated by clicking the right mouse button again. In this menu, for example, a counting function can be activated. The number of lines currently selected is then displayed.

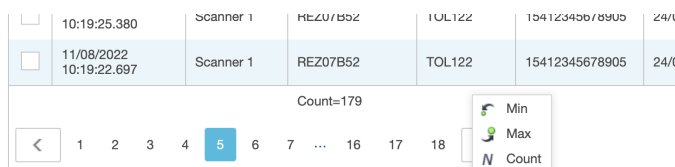
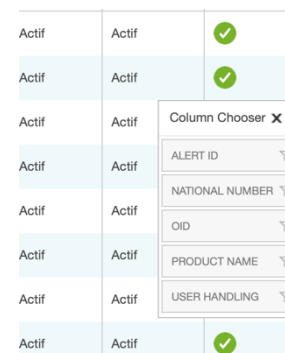
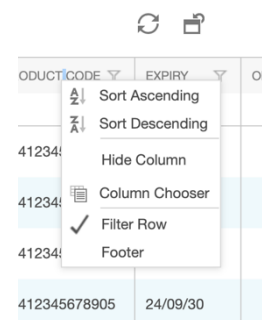

5.2 Settings of the Scan History

5.2.1 Number of records displayed

10, 20, 50, 100 or 200 lines can be displayed per page. The setting can be made through a drop-down menu at the bottom right edge.

5.2.2 Detailed information to a Scan

More information is available for each record than is shown in the default setting of the Scan History. Values shown in the standard display are marked with x:

DATE	x	time and date of scan (server time)
SCANNER	x	name of scanner
PRODUCT CODE	x	product code of scanned pack
SERIAL NUMBER	x	serial number of scanned pack
BATCH	x	batch of scanned pack
EXPIRY	x	expiry date of scanned pack

ONLINE	x	yes / no, pack scanned while Speed Scanner was online
FMD REQUEST	x	requested FMD operation to the NMVS
ICON	x	icon of result (full list in attachment)
RESULT	x	text message of the result (full list in download area)
PACK STATE	x	status of the pack after the FMD operation was performed
PRODUCT NAME		full name of the scanned product (optional)
MAH NAME		name of MAH (optional)
CUSTOM REFERENCE		Field for free use
NATIONAL NUMBER		national health reimbursement number (optional)
USER HANDLING		name of user who scanned the pack
OID		A unique key with which the record can be identified.

5.2.3 Visible Columns in the Scan History

To change the display of the Scan History, right-click on the table header. A context-sensitive menu opens. Two menu items control the table view. "Hide Column" removes a selected column from the view. "Column Chooser" opens another window that shows all parameters not previously displayed. Use the mouse to drag the required information to the top of the table. The required parameter is permanently displayed at this point.

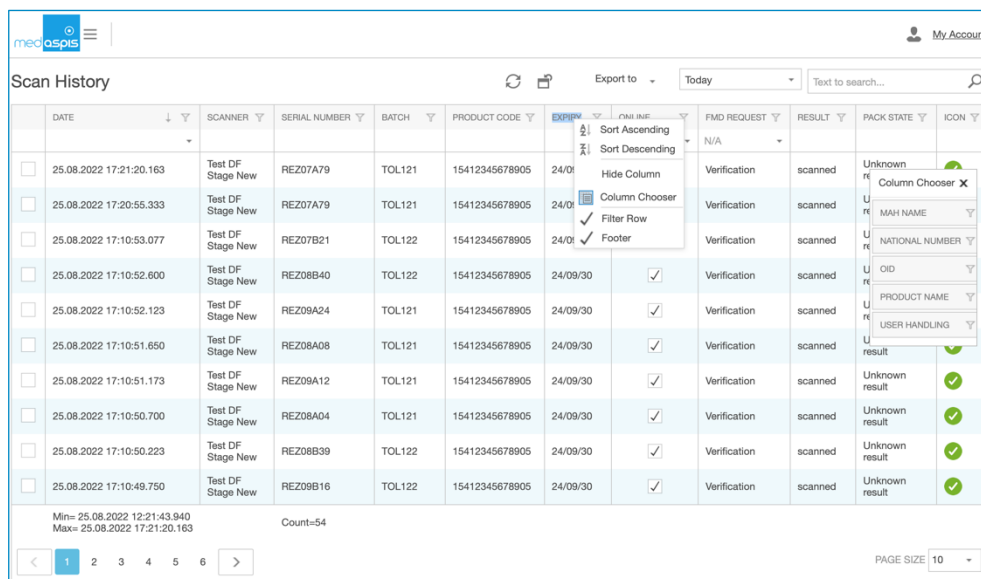

DATE	SCANNER	SERIAL NUMBER	BATCH	PRODUCT CODE	EXPIRY	ONLINE	FMD REQUEST	RESULT	PACK STATE	ICON
25.08.2022 17:21:20.163	Test DF Stage New	REZ07A79	TOL121	15412345678905	24/01		Verification	scanned	Unknown result	🟡
25.08.2022 17:20:55.333	Test DF Stage New	REZ07A79	TOL121	15412345678905	24/01		Verification	scanned	Unknown result	🟡
25.08.2022 17:10:53.077	Test DF Stage New	REZ07B21	TOL122	15412345678905	24/01		Verification	scanned	Unknown result	🟡
25.08.2022 17:10:52.600	Test DF Stage New	REZ08B40	TOL122	15412345678905	24/09/30	☑	Verification	scanned	Unknown result	🟢
25.08.2022 17:10:52.123	Test DF Stage New	REZ09A24	TOL121	15412345678905	24/09/30	☑	Verification	scanned	Unknown result	🟢
25.08.2022 17:10:51.650	Test DF Stage New	REZ08A08	TOL121	15412345678905	24/09/30	☑	Verification	scanned	Unknown result	🟢
25.08.2022 17:10:51.173	Test DF Stage New	REZ09A12	TOL121	15412345678905	24/09/30	☑	Verification	scanned	Unknown result	🟢
25.08.2022 17:10:50.700	Test DF Stage New	REZ08A04	TOL121	15412345678905	24/09/30	☑	Verification	scanned	Unknown result	🟢
25.08.2022 17:10:50.223	Test DF Stage New	REZ08B39	TOL122	15412345678905	24/09/30	☑	Verification	scanned	Unknown result	🟢
25.08.2022 17:10:49.750	Test DF Stage New	REZ09B16	TOL122	15412345678905	24/09/30	☑	Verification	scanned	Unknown result	🟢

Min= 25.08.2022 12:21:43.940
Max= 25.08.2022 17:21:20.163
Count=54

PAGE SIZE 10

6 Performing Grouping Operations

The medAspis system is able to process individual queries but can also work with groupings of packs. These groupings can be processed as a whole.

6.1 Groupings

Groupings are a list of packs that are grouped together under one key.

6.1.1 Grouping on the Speed Scanner

In the menu of the handheld device, the Grouping button is clicked. The device then expects the name of a grouping as the first input. This can be entered using the keyboard or a barcode is recorded. Alternatively, all machine-readable codes set in the handset menu will work, for example QR codes or 2D matrix codes.

The standard screen of the Speed Scanner changes. Additional information is provided. A line below the icon shows the name of the grouping and the number of packs already scanned into this group.

In addition, there are two buttons to complete or cancel the grouping. When the grouping is completed, this must still be confirmed with a "Confirm" button. The grouping can then be seen in the control panel under the menu item "Grouping".

If Batch Control is switched on, no packs with a different batch or product number are included in the grouping.

The entire FMD functionality is retained. FMD alert messages are always treated with top priority.

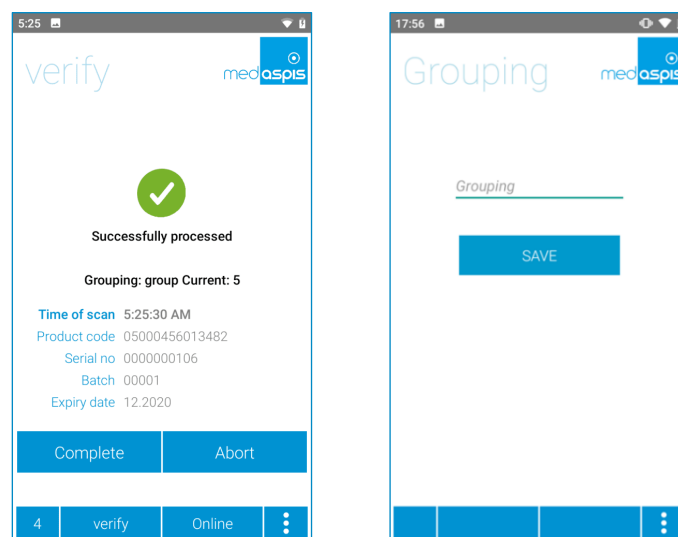

6.1.2 Grouping on the Control Panel

Groupings are called up via the menu in the control panel.

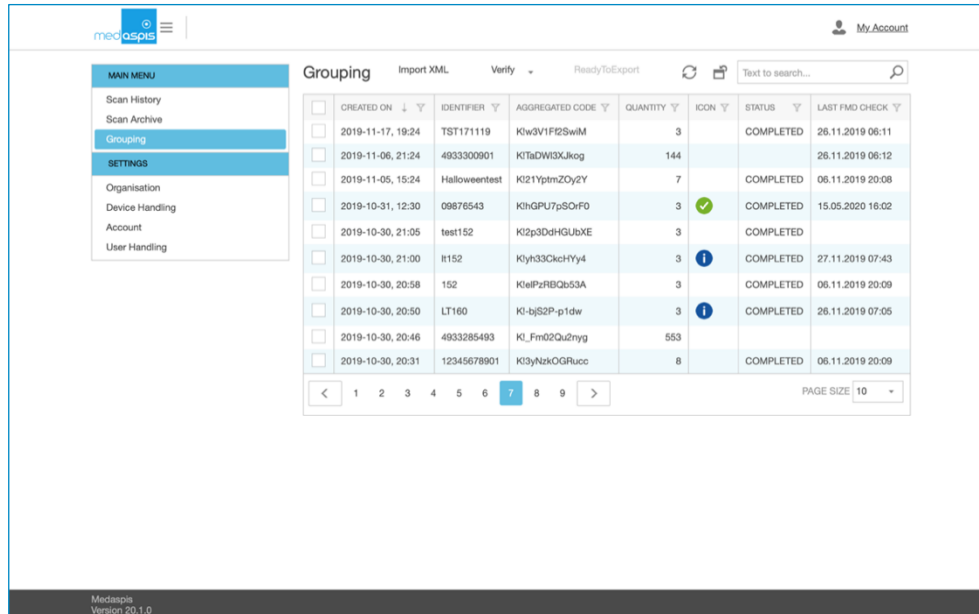

The screenshot shows the Medaspis control panel interface. On the left is a 'MAIN MENU' with options like 'Scan History', 'Scan Archive', 'Grouping', and 'SETTINGS'. The 'Grouping' section is active, displaying a table with columns: CREATED ON, IDENTIFIER, AGGREGATED CODE, QUANTITY, ICON, STATUS, and LAST FMD CHECK. The table contains 10 rows of grouping data. Below the table is a pagination control showing page 7 of 9 and a 'PAGE SIZE' dropdown set to 10.

CREATED ON	IDENTIFIER	AGGREGATED CODE	QUANTITY	ICON	STATUS	LAST FMD CHECK
2019-11-17, 19:24	TST171119	Klw3V1FZSwIM	3		COMPLETED	26.11.2019 06:11
2019-11-06, 21:24	4933300901	KTlaDWl3XJkqg	144		COMPLETED	26.11.2019 06:12
2019-11-05, 15:24	Halloweentest	KI21YptmZCy2Y	7		COMPLETED	06.11.2019 20:08
2019-10-31, 12:30	09876543	KthGPU7pSOiFO	3	✓	COMPLETED	15.05.2020 16:02
2019-10-30, 21:05	test152	KI2p3DdHGUbXE	3		COMPLETED	
2019-10-30, 21:00	It152	Klyh33CkclHYy4	3	!	COMPLETED	27.11.2019 07:43
2019-10-30, 20:58	152	KlelPzRBQb53A	3		COMPLETED	06.11.2019 20:09
2019-10-30, 20:50	LT160	KI-tyS2P-p1dw	3	!	COMPLETED	26.11.2019 07:05
2019-10-30, 20:46	4933285493	KI_Fm02Qu2nyg	553			
2019-10-30, 20:31	12345678901	KI3yNzckOGRucc	8		COMPLETED	06.11.2019 20:09

Various parameters are given for each grouping. Values shown in the standard display are marked with x:

IDENTIFIER	x	The name of the grouping chosen by the user.
QUANTITY	x	The number of packs included
ICON	x	The icon of the last FMD operation on the grouping.
AGGREGATION CODE	x	The system-assigned name (primary key) of the grouping.
STATUS	x	The current status of the grouping
LAST FMD CHECK	x	The time of the last FMD operation performed.
CUSTOM INFO 1		Field for free use
CUSTOM INFO 2		Field for free use
MODIFIED ON		The last time at which the grouping was processed

FMD operations can be performed on groupings. With the check boxes in the first column, groupings can be selected. The choices in the drop-down menu above are VERIFY, DISPENSE and EXPORT (see chapter 6.2).

Groupings can also be created by importing XML files with pack information. The XML format is described in Appendix 4.

Clicking on a line displays individual information of individual groupings.

6.1.3 View of a Single Grouping

From the list of groupings, individual groupings can be called up by clicking on the respective line of the overview.

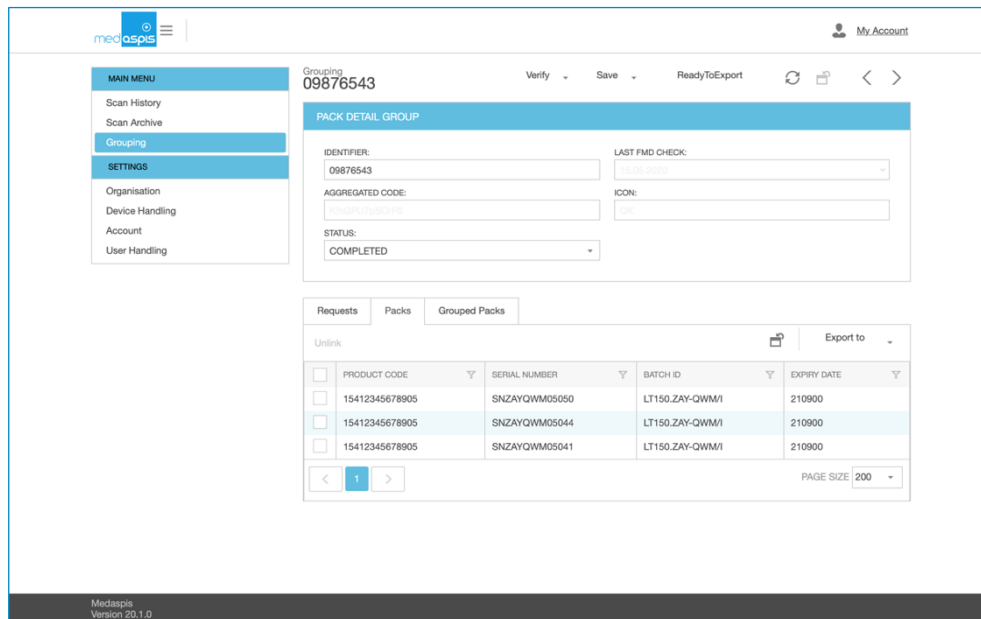

This view provides some general information about the grouping. The name and status of the grouping can be changed.

There are three tabs that contain further information of the grouping.

1. tab "Requests": All previous FMD operations on the entire grouping are displayed. The following parameters are displayed:

OPERATION	The selected FMD operation
DATE	The date of the operation
ICON	The icon of the result
RESULT	The result of the FMD operation

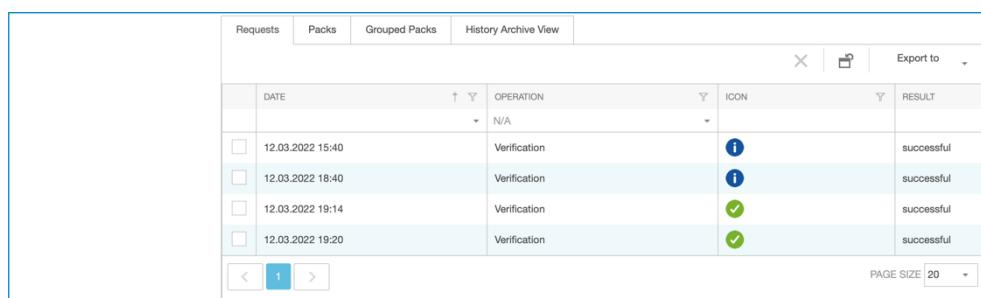

2. tab "Packs": A list of all packs included. The display corresponds to the Scan History display. The display of the parameters can be changed as in the Scan History.

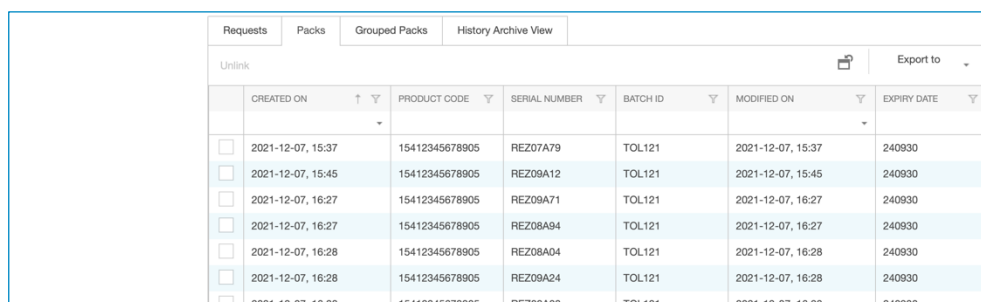

3. tab "Grouped Packs": A list of all contained packs sorted by different product codes and batches. If a grouping is not homogeneous, you can see it here at a glance.

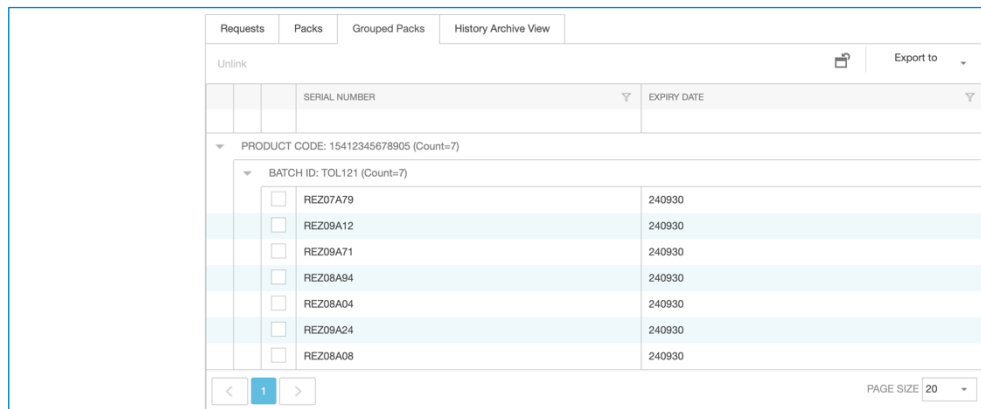

Requests		Packs	Grouped Packs	History Archive View
Unlink 🗑️ Export to ⌵				
	SERIAL NUMBER		EXPIRY DATE	
▼ PRODUCT CODE: 15412345678905 (Count=7)				
▼ BATCH ID: TOL121 (Count=7)				
<input type="checkbox"/>	REZ07A79		240930	
<input type="checkbox"/>	REZ09A12		240930	
<input type="checkbox"/>	REZ09A71		240930	
<input type="checkbox"/>	REZ08A94		240930	
<input type="checkbox"/>	REZ08A04		240930	
<input type="checkbox"/>	REZ09A24		240930	
<input type="checkbox"/>	REZ08A08		240930	
< 1 >				PAGE SIZE 20 ⌵

4. tab: "History View": In the groupings, the contained packs were previously displayed, but not the respective FMD status. With this release, the associated scan data is displayed for each group. This includes all attributes that can also be seen in the scan history.

If the scanned packs have been transferred to the Scan Archive in the meantime, a reference to the archive is automatically created. If packs are partly in the scan history and partly in the archive, both assignments are displayed.

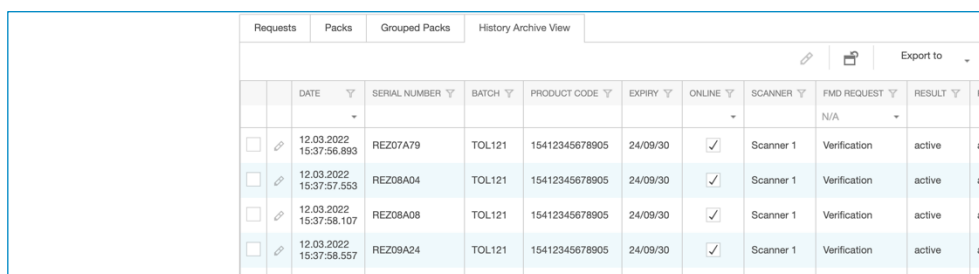

Requests		Packs	Grouped Packs	History Archive View						
Unlink 🗑️ Export to ⌵										
	DATE	SERIAL NUMBER	BATCH	PRODUCT CODE	EXPIRY	ONLINE	SCANNER	FMD REQUEST	RESULT	PA
<input type="checkbox"/>	12.03.2022 15:37:56.893	REZ07A79	TOL121	15412345678905	24/09/30	✓	Scanner 1	Verification	active	ac
<input type="checkbox"/>	12.03.2022 15:37:57.553	REZ08A04	TOL121	15412345678905	24/09/30	✓	Scanner 1	Verification	active	ac
<input type="checkbox"/>	12.03.2022 15:37:58.107	REZ08A08	TOL121	15412345678905	24/09/30	✓	Scanner 1	Verification	active	ac
<input type="checkbox"/>	12.03.2022 15:37:58.557	REZ09A24	TOL121	15412345678905	24/09/30	✓	Scanner 1	Verification	active	ac
	12.03.2022									

6.2 FMD Operations on groupings

An FMD operation on the grouping is initiated with the pull-down button at the top of the screen. VERIFY, DISPENSE, EXPORT and REACTIVATE are available. The FMD operation is applied to all packs in the grouping.

6.2.1 Perform FMD operations on groupings

A grouping is applied in the so-called "bulk mode". The entire content of the grouping is transferred to the NMVS in a single step. Processing takes some time, the result is not returned but is waiting for retrieval on the NMVS server.

The medAspis system checks at increasing intervals whether the processing of the bulks is ready. As long as processing is not completed on the NMVS side, a blue icon with a rotated arrow is displayed.

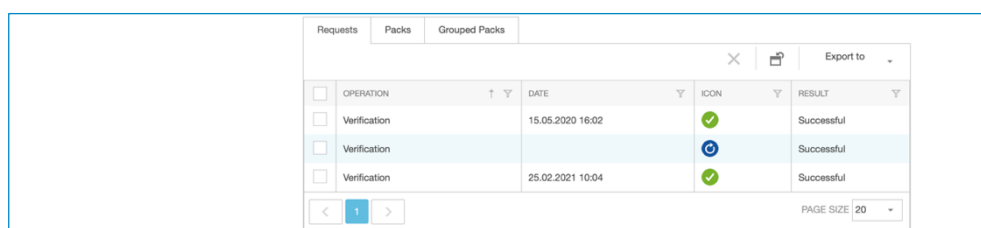

Requests		Packs	Grouped Packs	
Unlink 🗑️ Export to ⌵				
	OPERATION	DATE	ICON	RESULT
<input type="checkbox"/>	Verification	15.05.2020 16:02	✓	Successful
<input type="checkbox"/>	Verification		🔄	Successful
<input type="checkbox"/>	Verification	25.02.2021 10:04	✓	Successful
< 1 >				PAGE SIZE 20 ⌵

Whether processing is finished on the NMVS side can be determined by clicking the reload button. As soon as the data processing on the NMVS side is finished and can be retrieved, this icon is replaced by the result icon. The result of the bulk query then appears in the RESULT column and the corresponding green or red icon. The icon is a representation of the

most negative single result of the packs. If only one pack has a negative result, the entire bulk is marked with the red cross.

DATE	OPERATION	ICON	RESULT
15.05.2020 16:02	Verification	✓	Successful
25.02.2021 10:04	Verification	✓	Successful
27.02.2021 12:04	Verification	✗	Successful

More detailed information on the bulk operation is provided by clicking on the respective line. The immediately opening sub-window shows the packs contained in the grouping together with their respective FMD result. The view and functionality are the same as in the Scan History.

DATE	SERIAL NUMBER	BATCH	PRODUCT CODE	EXPIRY	ONLINE	RESULT	ICON	PACK STATE
27.02.2021 12:04:05.013	SNZAYQWM05041	LT150.ZAY-QWMI1	15412345678905	21/09	✓	Active	✓	Active
27.02.2021 12:04:05.047	SNZAYQWM05044	LT150.ZAY-QWMI1	15412345678905	21/09	✓	Active	✓	Active
27.02.2021 12:04:05.053	SNZAYQWM05050	LT150.ZAY-QWMI1	15412345678905	21/09	✓	inactive	✗	SUPPLIED

6.2.2 Special features of bulk operation in the Arvato system

Arvato handles the processing of bulk operations differently from the other two providers Solidsoft and securPharm in two respects:

Exception homogeneous bulks: Arvato allows wholesalers to process homogeneous bulks only. In these bulks, the product codes, batches and expiry dates must be the same for all packs. Only the serial number may vary. Requests with mixed bulks are returned as an error with no results reported on individual packs.

Exception: Return of individual pack results: As a rule, bulk operations return an individual pack result for each pack included. There is one exception to this rule at Arvato: If all the packs contained in a verify bulk operation have a positive result, an individual result is not delivered for each pack, but only for the entire bulk. There is only one result representing of all the packs included.

6.2.3 Mixed Bulk Operation

To offset the disadvantages of Arvato's processing of bulk FMD operations, there is the optional mixed bulk operation. The mixed bulk operation analyses a bulk batch before it is sent to an NMVS used by Arvato. If packs are found not to be of the same type and batch, the original bulk is split into homogeneous sub-bulks, which are then passed to the Arvato algorithm. The respective sub-segments are processed individually and later reassembled into the bulk that the user

originally intended to process. The mixed bulk operation runs entirely in the background; the user does not need to call up a separate operation.

Unlike in the original Arvato bulk operation, packages can be processed that have different FMD statuses at the time of scanning (e.g. one pack is active, another already deactivated). However, only operations permitted by the NMVS system are executed (e.g. reactivation within 10 days).

The mixed bulk operation also allows inter-market transactions.

6.3 Working with Groupings

Groupings are usually used to apply FMD operations to existing business processes. Either packs of business processes such as deliveries are processed together, or packs in distribution units such as cartons or pallets are grouped together.

6.3.1 Status of a Grouping

Groupings can have different statuses. The status can be used to describe the state of the grouping. Example: Packs can still be added to an open grouping, a grouping with the status "Completed" can no longer be changed.

UNDEFINED	default value before usage
OPEN	a grouping is on the way to get established
COMPLETED	a grouping is finished and able to be used
VERIFIED	a grouping is checked the first time
EXPORT	an aggregation is exported to use by third party
IMPORTED	a grouping was imported by a third party
CLOSED	The content of a grouping can not be changed any more

6.4 Aggregation as a special form of grouping

Aggregations are sub-forms of groupings. Aggregations have all the attributes of groupings but no user-assigned name and they can be used more flexibly.

6.4.1 Aggregation Code as primary key of any Grouping

Groupings always have a primary key (unique name). In medAspis, the primary key is a 64bit long unique identifier in base-64 notation. In this notation, the primary key is formed from letters, numbers and common special characters. medAspis uses the characters: A-Z, a-z, 0-9, + and -. Prefixed with a "K!", an example is "K!E9j-I9S4TVI".



Each grouping – no matter what name the user assigns – has a primary key formed in this way. The reason: Within the medAspis system, all groupings must be clearly identifiable. However, it may be that different customers use the same delivery note numbers for their grouping, for example. To be sure that all groupings can always be reliably identified and assigned in the system, the primary key is the aggregation code automatically generated for each grouping. This can never be changed or manipulated.

6.4.2 Hierarchical structure of aggregates

Using the aggregation codes as primary keys, groupings can be organised hierarchically. Aggregations can be part of a super-aggregation. This hierarchical relationship can take place in as many levels as required.

6.4.3 Exporting aggregations

Aggregations can be made visible to third parties. If the status of an aggregation is set to EXPORT, the aggregation is visible for others and can be taken over into the own data structure. Aggregations are passed on, for example, by sticking the aggregation code on an aggregated box. The receiver sees the code, scans it and has taken the data into its own data structure.

6.4.4 Aggregation codes on stickers

For easy processing of aggregations, medAspis provides lists with aggregation numbers to its customers.

7 Active Alert Management

The medAspis active Alert Management effectively protects you from false alarms and supports you in the few remaining suspicious cases. Once detected, false alarms reduce the burden of documentation and keep the operational process running. The few remaining cases are reliably identified, processed and documented. The effort required for compliance assurance in serialisation is significantly reduced.

The Alert Guard function is displayed in the main menu. Alert Guard is an additional service for which a fee is charged and which is only activated selectively.

7.1 Preventing false alarms with Alert Protect

The majority of false alarms occur when medicine packs are accidentally deactivated more than once. Double deactivations inevitably lead to falsification alerts that are forwarded to the authorities. medAspis consistently prevents these false alarms.

7.1.1 Double Dispense Filter

The original double dispense filter covers a period of 10 minutes. This period is increased to two hours.

Within this period, the same FMD operation (Disable, Export, Stolen, Destroy, Sample, etc.) will not be transmitted to the NMVS for a second verification.

7.2 Solve and document suspicious cases with Alert Guard

Alle Fälschungsverdachtsfälle werden im System erkannt und kenntlich gemacht.

7.2.1 Alert Overview

All critical cases are clearly presented. Instructions for action are available for scanning staff and supervisors.

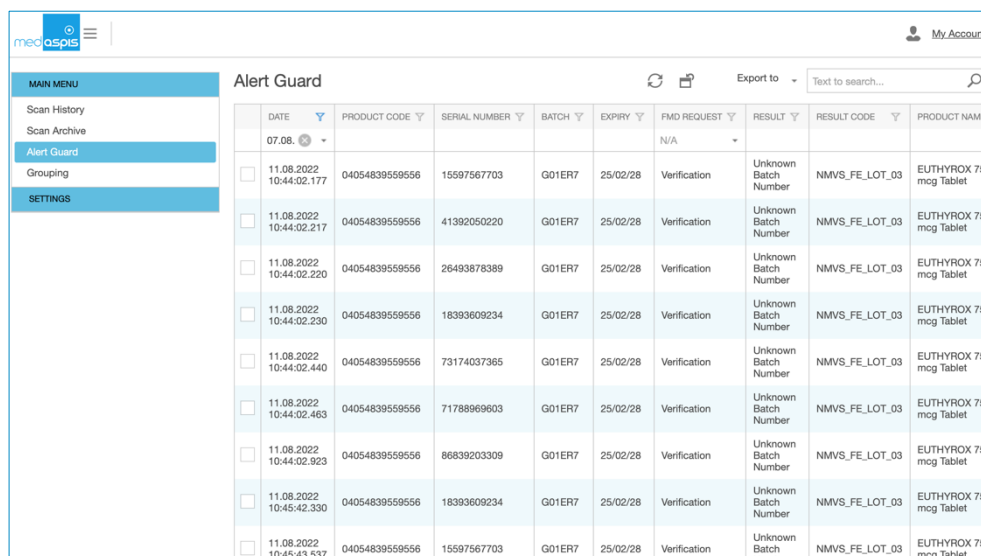

DATE	PRODUCT CODE	SERIAL NUMBER	BATCH	EXPIRY	FMD REQUEST	RESULT	RESULT CODE	PRODUCT NAME
11.08.2022 10:44:02.177	04054839559556	15597567703	G01ER7	25/02/28	Verification	Unknown Batch Number	NMVS_FE_LOT_03	EUTHYROX 75 mcg Tablet
11.08.2022 10:44:02.217	04054839559556	41392050220	G01ER7	25/02/28	Verification	Unknown Batch Number	NMVS_FE_LOT_03	EUTHYROX 75 mcg Tablet
11.08.2022 10:44:02.220	04054839559556	26493878389	G01ER7	25/02/28	Verification	Unknown Batch Number	NMVS_FE_LOT_03	EUTHYROX 75 mcg Tablet
11.08.2022 10:44:02.230	04054839559556	18393609234	G01ER7	25/02/28	Verification	Unknown Batch Number	NMVS_FE_LOT_03	EUTHYROX 75 mcg Tablet
11.08.2022 10:44:02.440	04054839559556	73174037365	G01ER7	25/02/28	Verification	Unknown Batch Number	NMVS_FE_LOT_03	EUTHYROX 75 mcg Tablet
11.08.2022 10:44:02.463	04054839559556	71788869603	G01ER7	25/02/28	Verification	Unknown Batch Number	NMVS_FE_LOT_03	EUTHYROX 75 mcg Tablet
11.08.2022 10:44:02.923	04054839559556	86839203309	G01ER7	25/02/28	Verification	Unknown Batch Number	NMVS_FE_LOT_03	EUTHYROX 75 mcg Tablet
11.08.2022 10:45:42.330	04054839559556	18393609234	G01ER7	25/02/28	Verification	Unknown Batch Number	NMVS_FE_LOT_03	EUTHYROX 75 mcg Tablet
11.08.2022 10:45:43.537	04054839559556	15597567703	G01ER7	25/02/28	Verification	Unknown Batch Number	NMVS_FE_LOT_03	EUTHYROX 75 mcg Tablet

DATE	x	time and date of scan (server time)
PRODUCT CODE	x	product code of scanned pack
SERIAL NUMBER	x	serial number of scanned pack

BATCH	x	batch of scanned pack
EXPIRY	x	expiry date of scanned pack
FMD REQUEST	x	requested FMD operation to the NMVS
RESULT	x	text message of the result (full list in download area)
RESULT CODE	x	The alert code specified by the NMVS (e.g. SP-201 or NMVS_LOT_03).
PRODUCT NAME		full name of the scanned product (optional)
MAH NAME		name of MAH (optional)
NATIONAL NUMBER		national health reimbursement number (optional)
OID		A unique key with which the record can be identified.
PACK STATE		status of the pack after the FMD operation was performed
USER HANDLING		name of user who scanned the pack

Clicking on a line displays more details about the falsification alert, including detailed instructions for the scanning staff and the responsible person.

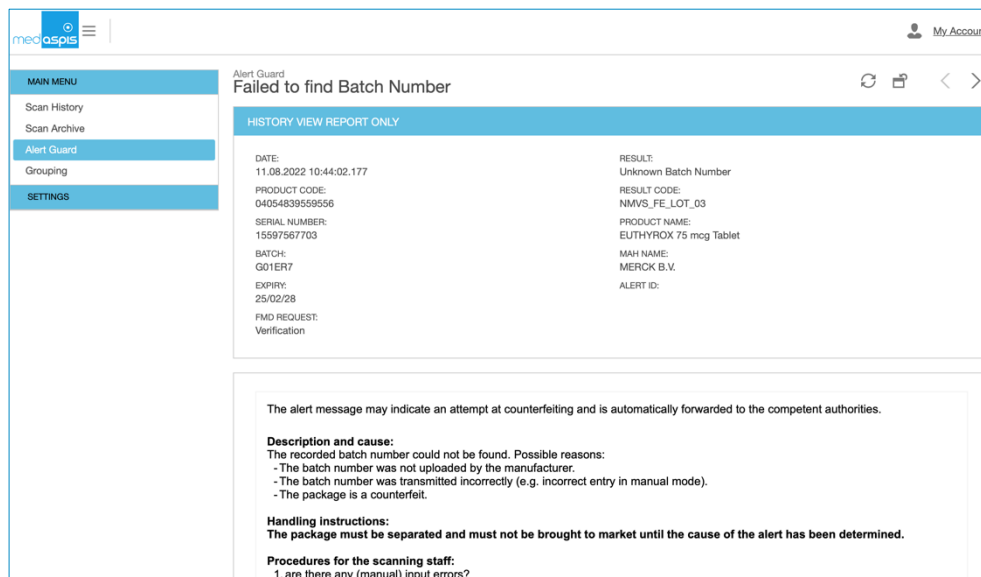

The screenshot shows the 'Alert Guard' interface. The title is 'Failed to find Batch Number'. Below the title is a table with the following details:

HISTORY VIEW REPORT ONLY	
DATE:	11.08.2022 10:44:02.177
PRODUCT CODE:	0405483959556
SERIAL NUMBER:	15597567703
BATCH:	G01ER7
EXPIRY:	25/02/28
FMD REQUEST:	Verification
RESULT:	Unknown Batch Number
RESULT CODE:	NMVS_FE_LOT_03
PRODUCT NAME:	EUTHYROX 75 mcg Tablet
MAH NAME:	MERCK B.V.
ALERT ID:	

Below the table, there is a text box with the following content:

The alert message may indicate an attempt at counterfeiting and is automatically forwarded to the competent authorities.

Description and cause:
The recorded batch number could not be found. Possible reasons:
- The batch number was not uploaded by the manufacturer.
- The batch number was transmitted incorrectly (e.g. incorrect entry in manual mode).
- The package is a counterfeit.

Handling instructions:
The package must be separated and must not be brought to market until the cause of the alert has been determined.

Procedures for the scanning staff:
1. are there any (manual) input errors?

7.2.2 Alert Guard Report

A PDF report can be generated from the currently displayed alert overview at any time using the export function. This report shows the most important attributes of the suspected falsification alert. In a separate field, comments can be made on the specific case.



Alert Guard Report

11.08.2022 10:46:14	Failed to find Batch Number	FMD Request	Verification
Product Code	04054839559556	Manufacturer	MERCK B.V.
Serial Number	15597567703	Product Name	EUTHYROX 75 mcg Tablet
Batch	G01ER7		
Expiry	25/02/28		
Alert Code NMVS_FE_LOT_03 - Unknown Batch Number			
Description The package must be separated and must not be placed on the market until the cause of the alert has been determined. Photograph the 2D matrix code and the data in human readable form and follow the instructions of your NMVO.			
Measure	<input type="text"/>	Completed	<input type="checkbox"/>
11.08.2022 10:44:02	Failed to find Batch Number	FMD Request	Verification
Product Code	04054839559556	Manufacturer	MERCK B.V.
Serial Number	41392050220	Product Name	EUTHYROX 75 mcg Tablet
Batch	G01ER7		
Expiry	25/02/28		
Alert Code NMVS_FE_LOT_03 - Unknown Batch Number			
Description The package must be separated and must not be placed on the market until the cause of the alert has been determined. Photograph the 2D matrix code and the data in human readable form and follow the instructions of your NMVO.			
Measure	<input type="text"/>	Completed	<input type="checkbox"/>
11.08.2022 10:45:50	Failed to find Batch Number	FMD Request	Verification

8 Offline Processing

In general, all scans captured with the FMD Speed Scanner are immediately forwarded to the FMD server and processed there. The records are then checked at the NMVS and the check result is displayed in the scan history and on the FMD Speed Scanner.

Unfortunately, it cannot be avoided that the internet connection between the FMD Speed Scanner and the FMD server is disturbed. This can have various reasons:

- The capturing software on the FMD Speed Scanner is not working properly or the FMD Server is not responding.
- The technical equipment on site is disturbed.
- The FMD Speed Scanner's connection to the Internet is temporarily disrupted.

The most common cause is an often only short interruption to the Internet. This can happen if not all areas of the warehouse are covered by the local router or if scanning has to take place in a location that is unsuitable for wireless transmission, e.g. in the cold store.

8.1 On the FMD Speed Scanner

If the connection to the Internet is lost, the FMD Speed Scanner detects this immediately. On the handheld device, the status changes to Offline (visible in the bottom line) and a yellow warning icon with a short explanatory text appears.

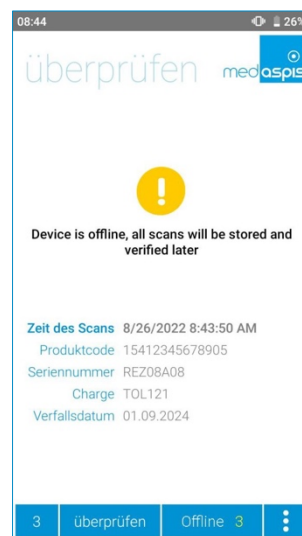

Nevertheless, the FMD Speed Scanner remains operational. Data is recorded, work does not have to be interrupted. All codes captured during the offline phase are saved in the handheld device itself; under no circumstances data records are lost. The number of codes captured in this phase is shown in yellow in the bottom bar.

However, the operational functionality is limited. As there is no access to the internet, the data cannot be transferred to the FMD server and direct processing by the responsible NMVS cannot take place either.

As soon as the Internet connection is re-established, all data records recorded and temporarily stored in the FMD Speed Scanner are transferred to the server. Depending on the amount of data, this may take a while.

8.2 Further Processing in the Scan History

All data records transferred by the handheld device after the offline phase is ended are displayed in the scan history. This data can be recognised by the missing ticks in the ONLINE column and the status of the pack. As there is no information about the status of the pack from the NMVS, the status is marked as unknown.

DATE	SERIAL NUMBER	BATCH	PRODUCT CODE	EXPIRY	ONLINE	FMD REQUEST	RESULT	PACK STATE	ICON
26.08.2022 09:06:04.290	REZ07B52	TOL122	15412345678905	24/09/30	<input type="checkbox"/>	Verification	scanned	Unknown result	✓
26.08.2022 09:06:04.287	REZ09A71	TOL121	15412345678905	24/09/30	<input type="checkbox"/>	Verification	scanned	Unknown result	✓
26.08.2022 09:06:03.630	REZ08A94	TOL121	15412345678905	24/09/30	<input type="checkbox"/>	Verification	scanned	Unknown result	✓
26.08.2022 09:05:59.070	REZ08B40	TOL122	15412345678905	24/09/30	<input checked="" type="checkbox"/>	Verification	active	active	✓
26.08.2022 09:05:57.313	REZ08B39	TOL122	15412345678905	24/09/30	<input checked="" type="checkbox"/>	Verification	active	active	✓
26.08.2022 09:05:29.020	REZ09A12	TOL121	15412345678905	24/09/30	<input checked="" type="checkbox"/>	Verification	active	active	✓
26.08.2022 09:05:27.143	REZ09A24	TOL121	15412345678905	24/09/30	<input checked="" type="checkbox"/>	Verification	active	active	✓
26.08.2022 09:05:25.120	REZ08A08	TOL121	15412345678905	24/09/30	<input checked="" type="checkbox"/>	Verification	active	active	✓
26.08.2022 09:05:23.137	REZ08A04	TOL121	15412345678905	24/09/30	<input checked="" type="checkbox"/>	Verification	active	active	✓
26.08.2022 09:05:22.423	REZ07A79	TOL121	15412345678905	24/09/30	<input checked="" type="checkbox"/>	Verification	active	active	✓

ATTENTION: The FMD operations recorded during the offline phase are NOT executed. Since it is not known how long the unit was offline and because a replacement scan may have already been performed, the subsequent execution of FMD operations is left to the user.

If the entries marked as offline are sent to the NMVS, this must be done by scanning them again. However, the packs are no longer needed for this.

First filter the packs marked as offline.

EXPIRY	ONLINE	FMD REQUEST	RESULT
24/09/30	<input type="checkbox"/>	N/A	
05 24/09/30	<input checked="" type="checkbox"/>	Verification	scann
05 24/09/30	<input type="checkbox"/>	Verification	scann
05 24/09/30	<input type="checkbox"/>	Verification	scann

Click the first filtered line. The detailed data for this scan will appear. Among other things, you will see a 2D matrix code. This code can be scanned with the FMD Speed Scanner as if scanning from the pack. Scan this code with the desired FMD operation. The scan results in a new entry in the Scan History.

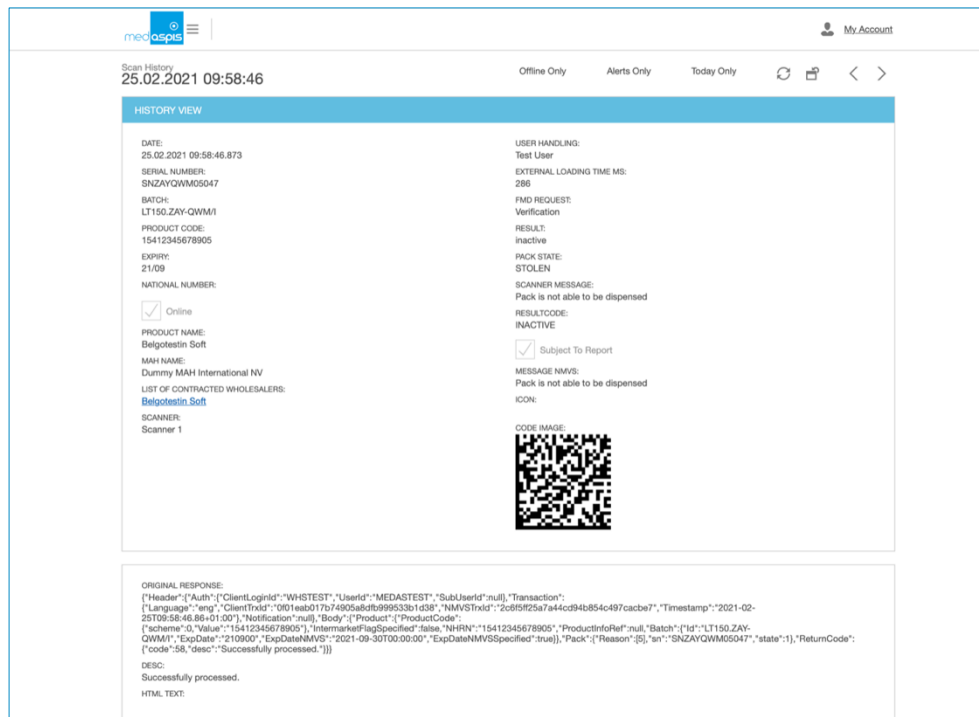

medaspis My Account

Scan History 25.02.2021 09:58:46 Offline Only Alerts Only Today Only

HISTORY VIEW

<p>DATE: 25.02.2021 09:58:46.873</p> <p>SERIAL NUMBER: SNZAYQWM05047</p> <p>BATCH: LT150.ZAY-QWM/1</p> <p>PRODUCT CODE: 15412345678905</p> <p>EXPIRY: 21/09</p> <p>NATIONAL NUMBER: <input checked="" type="checkbox"/> Online</p> <p>PRODUCT NAME: Belgotestin Soft</p> <p>MAH NAME: Dummy MAH International NV</p> <p>LIST OF CONTRACTED WHOLESALERS: Belgotestin Soft</p> <p>SCANNER: Scanner 1</p>	<p>USER HANDLING: Test User</p> <p>EXTERNAL LOADING TIME MS: 286</p> <p>FMD REQUEST: Verification</p> <p>RESULT: Inactive</p> <p>PACK STATE: STOLEN</p> <p>SCANNER MESSAGE: Pack is not able to be dispensed</p> <p>RESULTCODE: INACTIVE</p> <p><input checked="" type="checkbox"/> Subject To Report</p> <p>MESSAGE NMV5: Pack is not able to be dispensed</p> <p>ICON: </p>
--	--

ORIGINAL RESPONSE:

```
[{"Header":{"Auth":{"ClientLoginId":"WHSTEST","UserId":"MEDASTEST","SubUserId":null},"Transaction":{"Language":"eng","ClientTrid":"001eab017b74905a8dfb999533b1d38","NMVSTrid":"2cb9f925a7e4cd94b854c497cacbe7","Timestamp":"2021-02-25T09:58:46.8640100"},"Notification":null,"Body":{"Product":{"ProductCode":{"scheme":"0","Value":"15412345678905"},"IntermarketFlagSpecified":false,"NMVSN":"15412345678905","ProductInfoRef":null,"Batch":{"id":"LT150.ZAY-QWM/1","ExpDate":"210900","ExpDateNMV5":"2021-09-30T00:00:00","ExpDateNMV5Specified":true},"Pack":{"Reason":"S","sn":"SNZAYQWM05047","state":1},"ReturnCode":{"code":"S6","desc":"Successfully processed."}}}]
```

DESIG:
Successfully processed.

HTML TEXT:

The navigation arrows in the top right-hand corner can be used to jump immediately to the detail view of the next offline pack. These arrows are active until the last offline pack has been reached.

9 Maintaining the Lean FMD System

9.1 Renewal of a Certificate

From time to time, the access certificates must be renewed. The procedures differ depending on the Blueprint provider:

9.1.1 securPharm

The renewal of your certificate is requested via the NGDA portal. You will then receive a letter from the NGDA containing a TAN that you can now use in your medAspis Control Panel.

The required field can be found in the menu in the Control Panel under the securPharm Access tab.

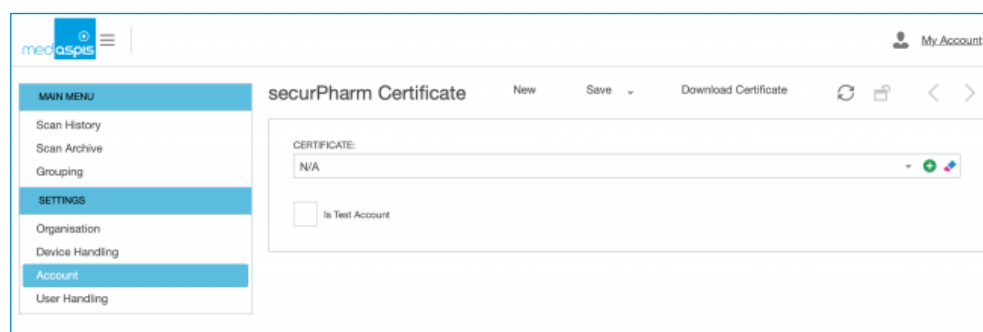

Click on "Download certificate" to open a window in which you will be asked for your NID (establishment number, beginning with APO) and a one-time password. Please enter the password you received from the NGDA and click OK. The certificate is uploaded automatically.

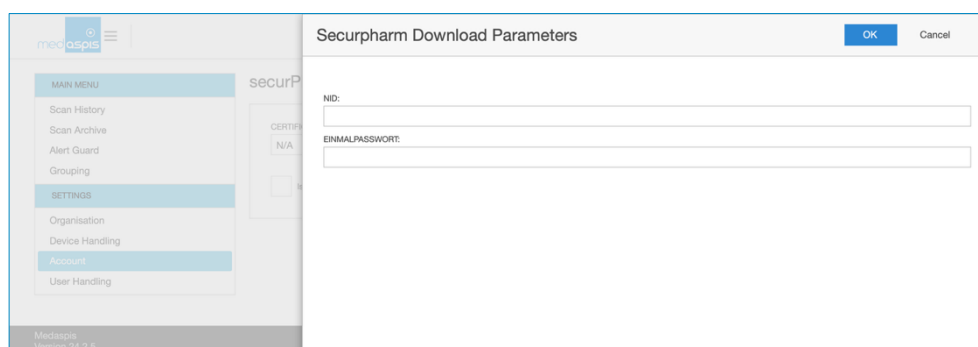

Save the changes and the new certificate is activated and connected to your account.

Manual download of the certificate:

If you have already downloaded the certificate (.p12 file) via the NGDA portal, you can also include it directly as a file in your ControlPanel.

To do this, please click on the green "+" symbol under ControlPanel/securPharm Access, "search" your PC for the certificate and enter the certificate password in the "Private Key Password" column. The column "Public Key Token" should remain empty.

"Save" the changes and the new certificate is activated and connected to your account.

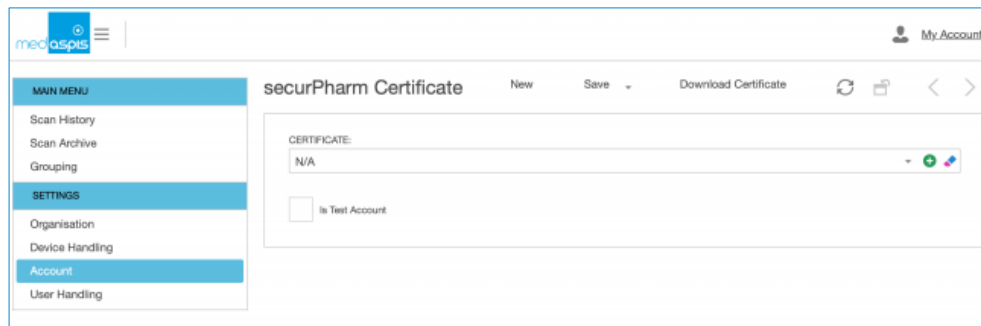

Please do not forget to complete the process by pressing the SAVE button.

9.1.2 Arvato

You must request a new certificate from your NMVO. In the example presented here, this is SEVeM, the Spanish NMVO. In this case, the response is a user name, a TAN code and a URL.

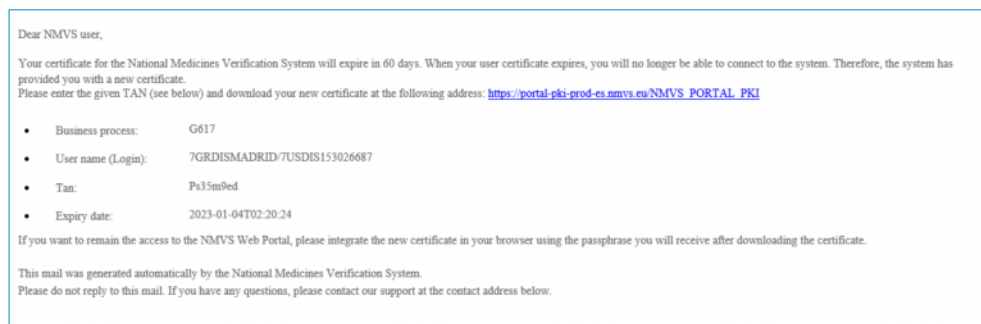

From now on, the process continues in the medAspis Control Panel. Please go to the Account tab in the menu. Ensure that the fields under "Certificate" are populated with your valid Client ID and Client Secret (your NMVS credentials). Please click "Update certificate"

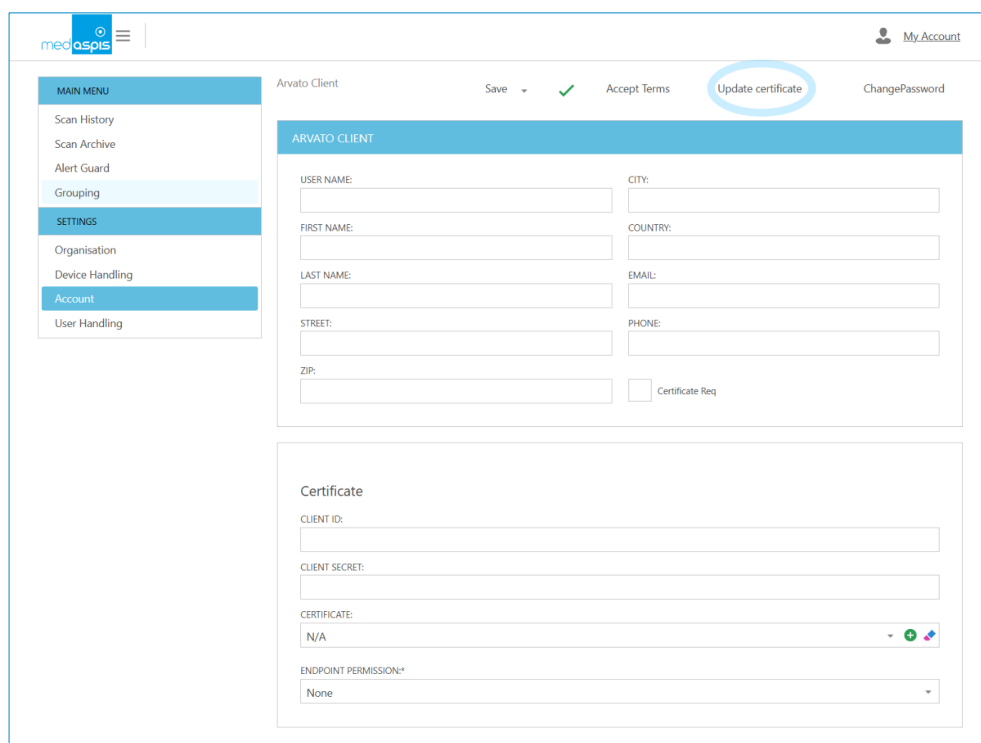

In the following window, enter the TAN received earlier in the process and click on “OK”.

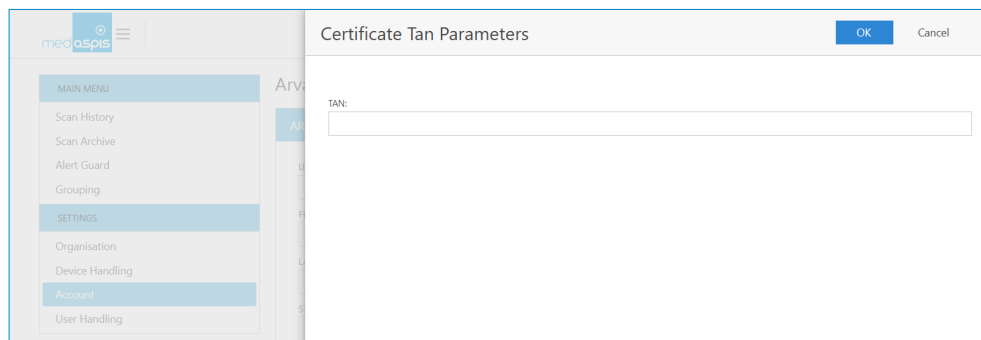

Please do not forget to end the process by pressing the SAVE button at the top of the screen. You have now set up your new certificate.

9.2 Updating the Speed Scanner via F-Droid

9.2.1 Manual Software Updating

medAspis will periodically issue updated versions of the application software. The system continuously checks for updates and installs them automatically. These automatic installations may – very rarely – not succeed, meaning the medAspis application update needs to be performed manually. Please see below the instructions for manual software updating.

On the screen, just swipe up the screen and you open the list of programs on the device (Android users will be very familiar with this).

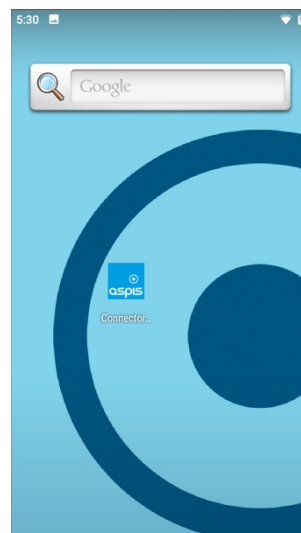

Select the application 'F-Droid'. This program is responsible for updates.

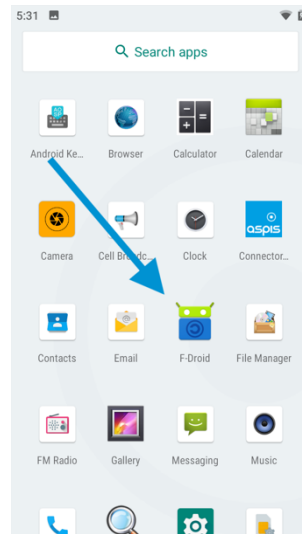

You should see the medAspis Connector+ application on the screen; if not, press 'Latest' on the bottom row. If you still do not see the medAspis Connector Plus application, try the search function on the bottom right and search for 'medAspis'. The application should be visible.

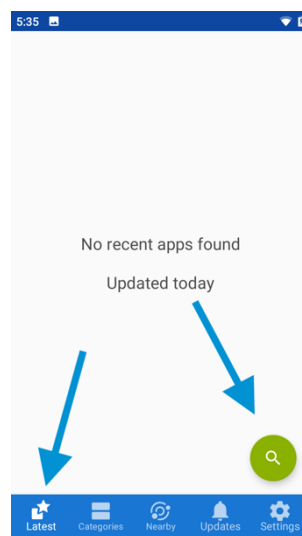

Tap the Connector+ application; details of the medAspis application appear.

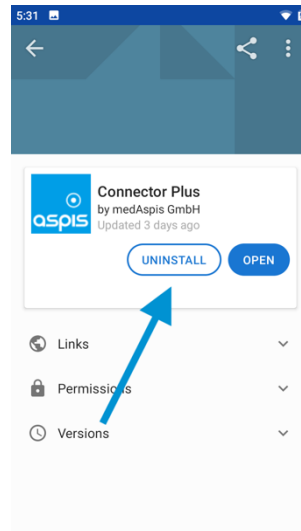

You will be asked if you want to uninstall or open the medAspis application. Please choose to uninstall and complete the de-installation process. Do not worry, the application will not be lost; a fresh version will be reloaded.

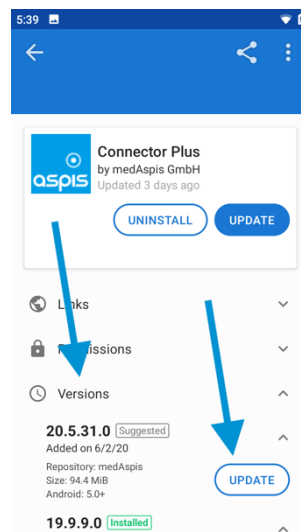

Please click on 'Versions'. This shows several versions to choose from. Touch the top version labelled 'suggested' (this is the most up-to-date version).

Touch 'Install' and follow the installation instructions.

9.2.2 Automated Software Updating

Open the F-Droid (instructions are similar to Manual Software Updating) and click on Settings. A page will open that will be like the one in the picture below. Scroll down to see the Updates.



Configure the Automatic Updating similar to the settings in the picture. Make sure that the Speed Scanner remains connected to the Internet. Once a new release of software will be available, the F-Droid will register it and update the application.

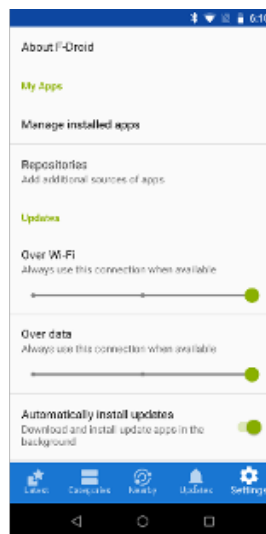

9.2.3 Installation of test versions of the medAspis App

To use a test instance of the software, the existing app must be deleted and a test instance of the Connector+ software must be loaded from a test repository in F-Droid. The Connector+ app for the productive system is in the "medAspis" repository, whereas the test app is in "medAspis staging".

Start F-Droid from the Android interface of the handheld scanner and go to the settings (bottom right in the F-Droid app). After clicking on the "Repositories" button, a list of all active repositories appears. In any case, there is a repository "medAspis", the repository "medAspis staging F-Droid Repository" could also appear. This staging repository must be activated, the "medAspis" repository must be deactivated.

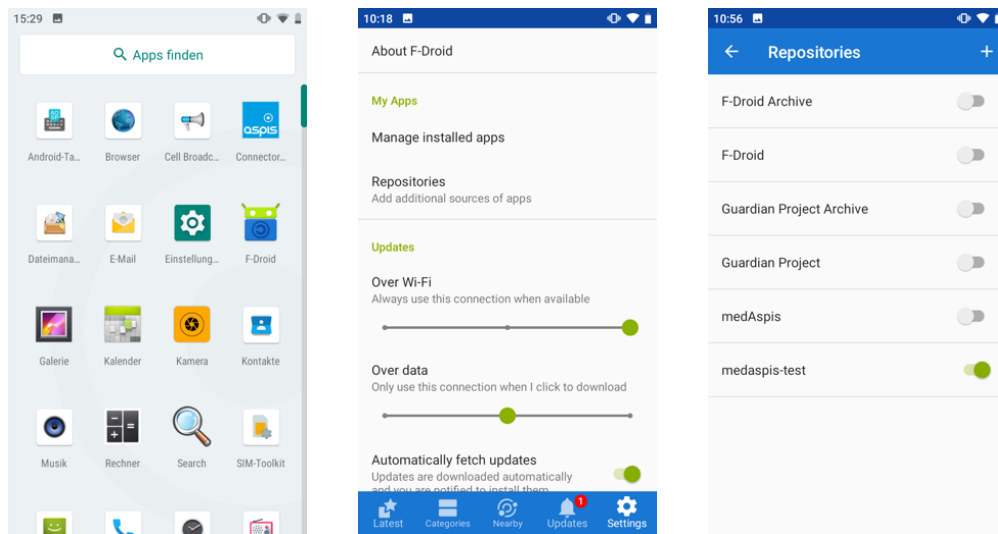

If the test repository has not yet been created, the following steps must be carried out in the browser of the handheld device:

Open the browser of the Speed Scanner and enter this URL <https://apps.staging.medaspis.org>. A web page from F-Droid appears. Please click on the button "ADD TO F-DROID" in the upper part of the window. Another window will open immediately. Please click on the button "I HAVE F-DROID". On the page that then appears, please confirm the displayed data with the OK button. The test repository is now created on F-Droid.

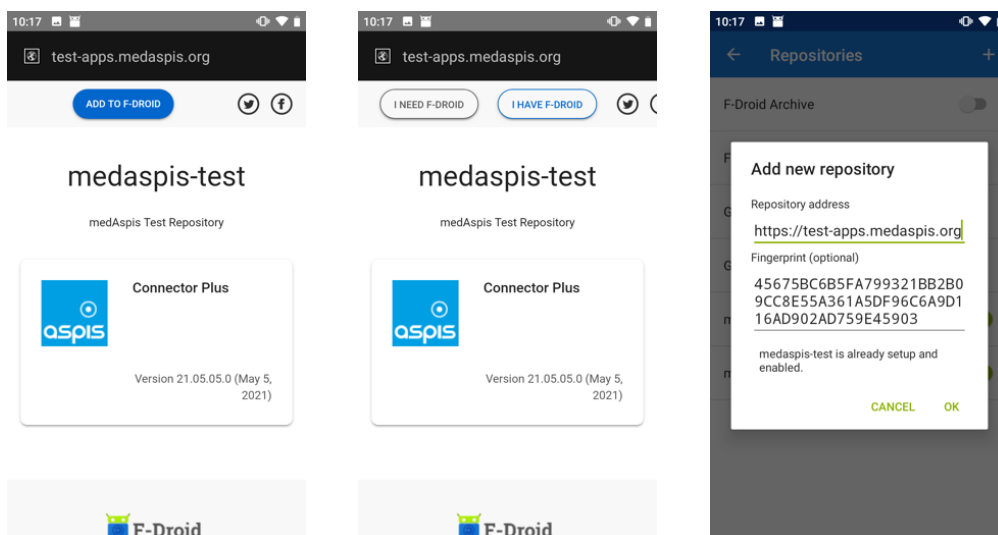

Switch back to F-Droid, go to the settings and click on "Repositories". Now you can see all the data directories from which new applications can be loaded. To be sure that only the test application is loaded, please switch on the test repository "medaspis test" and switch off the productive repository "medAspis". Switch back to the main F-Droid interface. Click "Latest" in the menu at the bottom left. You may already see the medAspis app now. If not, please use the search button on the bottom right. Type "medAspis" in the search field. The app appears and can be clicked on.

First, please click the UNINSTALL button to delete the existing app. Don't worry, in the next step the app will be loaded again. Please follow the further instructions of the uninstall process. As the next step, please follow the instructions to install the new software.

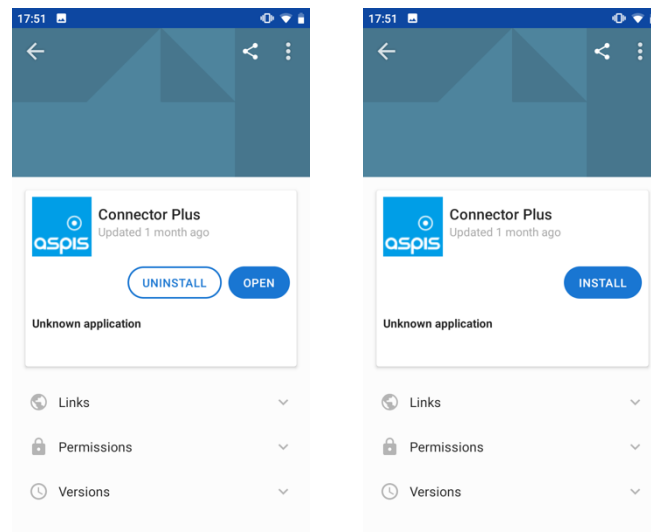

The test software is now installed, and the handheld device can be used in test mode. Please decide how you want to test the new app. A test panel is available for a complete test, but the app also works in the productive environment.

You can reach the test panel at <https://panel.staging.medAspis.org>, the productive environment can be found as usual at <https://panel.medAspis.org>.

You must activate the app in the respective preferred environment. If your device is still connected to the system after installing the new app, please press the logo 5 times in succession in the app settings. The device then switches to enrolment mode, in which the device can be enrolled in a new environment.

Now start the panel in the productive or test environment. If you use the test environment, you should know that the packs scanned in this environment cannot later be transferred to the productive environment. However, the test environment is also connected to your NMVS. If you want to avoid this, please ask your NMVO for a test environment and re-enter the access data.

Attention: It is important to follow the de-installation and re-installation routine because the originally loaded productive application must be deleted before the test application can be installed.

Attention: Please do not forget to load a production app again after testing the app in order to continue with productive work. To do this, you must switch off the test repository "medaspis-test" and switch on the productive repository "medAspis" in the same way as described above. Again, you must delete the current test app and reload the Connector+ app that is then offered. Make sure that the codes scanned with the new app appear under <https://panel.medAspis.com> in the productive environment. If this is not the case, please repeat the installation procedure.

10 Attachments

10.1 Attachment: Icons

The symbols used in the system follow a colour scheme:

10.1.1 NMVS colours:

The symbols of the NMVS answers are shown in the familiar traffic light colours green, yellow and red.



10.1.2 System colours:

Other symbols for additional system information of the medAspis system are in blue.

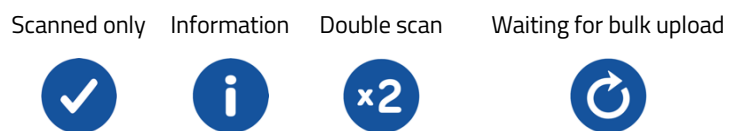

10.2 Attachment: XML format for importing pack data

XML files with the following sample format can be imported.

```
<?xml version="1.0" encoding="UTF-8"?>
<Shipment snr="grouping">
  <Content dfi="IFA">
    <PPN>111234567842</PPN>
    <LOT>1A234B5</LOT>
    <EXP>151231</EXP>
    <SN>1234567890123456</SN>
  </Content>
  <Content dfi="GS1">
    <GTIN>04150123456792</GTIN>
    <LOT>1A234B6</LOT>
    <EXP>151232</EXP>
    <SN>1234567890123457</SN>
  </Content>
</Shipment>
```